

MAIN PARK

11205 S MAIN ST, HOUSTON, TX 77025



**SOUTHWEST FAR HOUSTON
SUBMARKET**



GLASS STOREFRONT



STREET FRONTAGE



GRADE LEVEL LOADING



AMPLE SURFACE PARKING



**GREAT ACCESS TO HWY-90
AND I-610**



22' CLEAR HEIGHT



TENANT-CONTROLLED HVAC



DOCK-HIGH LOADING



3610 & 3620 WILLOWBEND BLVD, HOUSTON, TX 77054

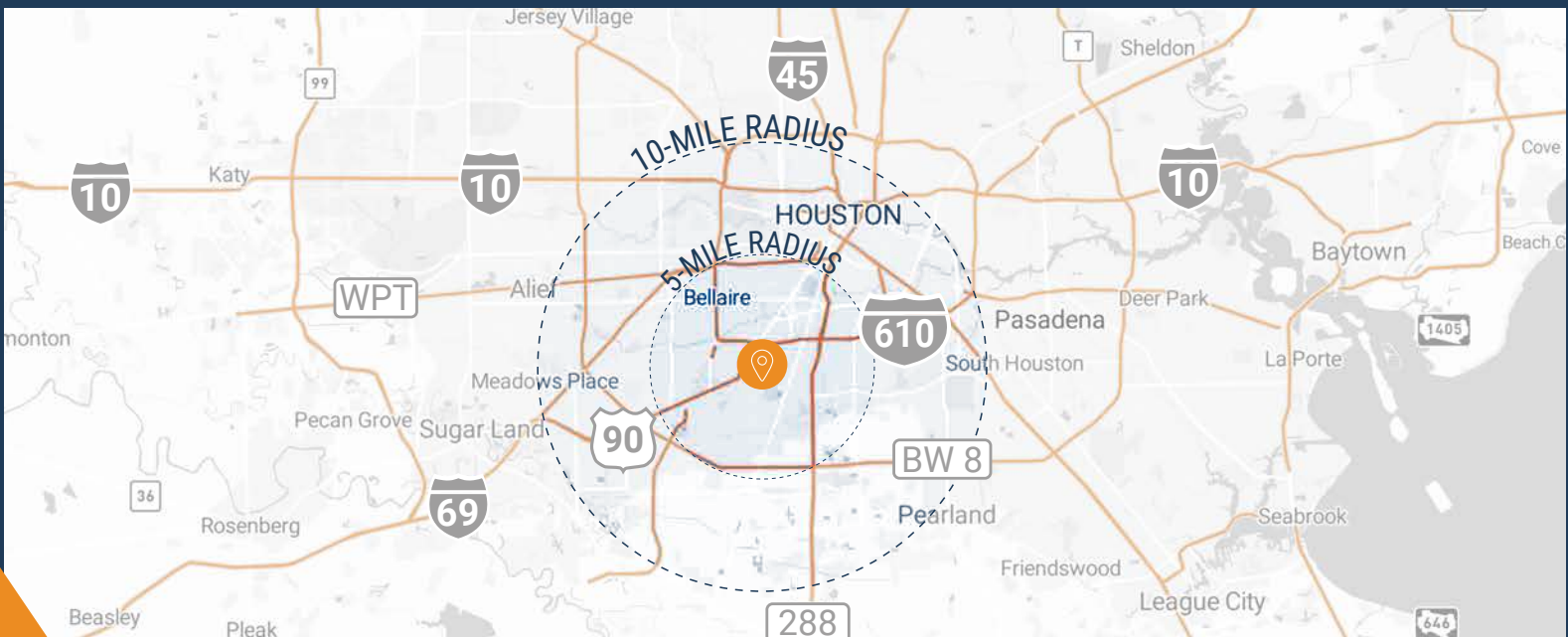

THOMAS PFEIFER



281.504.7460



THOMAS.PFEIFER@FORT-COMPANIES.COM



FORT CAPITAL

This information is deemed reliable, however, Fort Capital makes no guarantee, warranties, or representations as to the completeness or accuracy thereof.

SITE PLAN



THOMAS PFEIFER



281.504.7460



THOMAS.PFEIFER@FORT-COMPANIES.COM

This information is deemed reliable, however, Fort Capital makes no guarantee, warranties, or representations as to the completeness or accuracy thereof.



FLOOR PLAN – AVAILABLE IMMEDIATELY

- » 7,463 SF Total Available
 - » 2,133 SF Office
 - » 5,330 SF Warehouse
- » 19 FT Clear Height
- » (1) Ramp
- » (3) Dock-High Doors

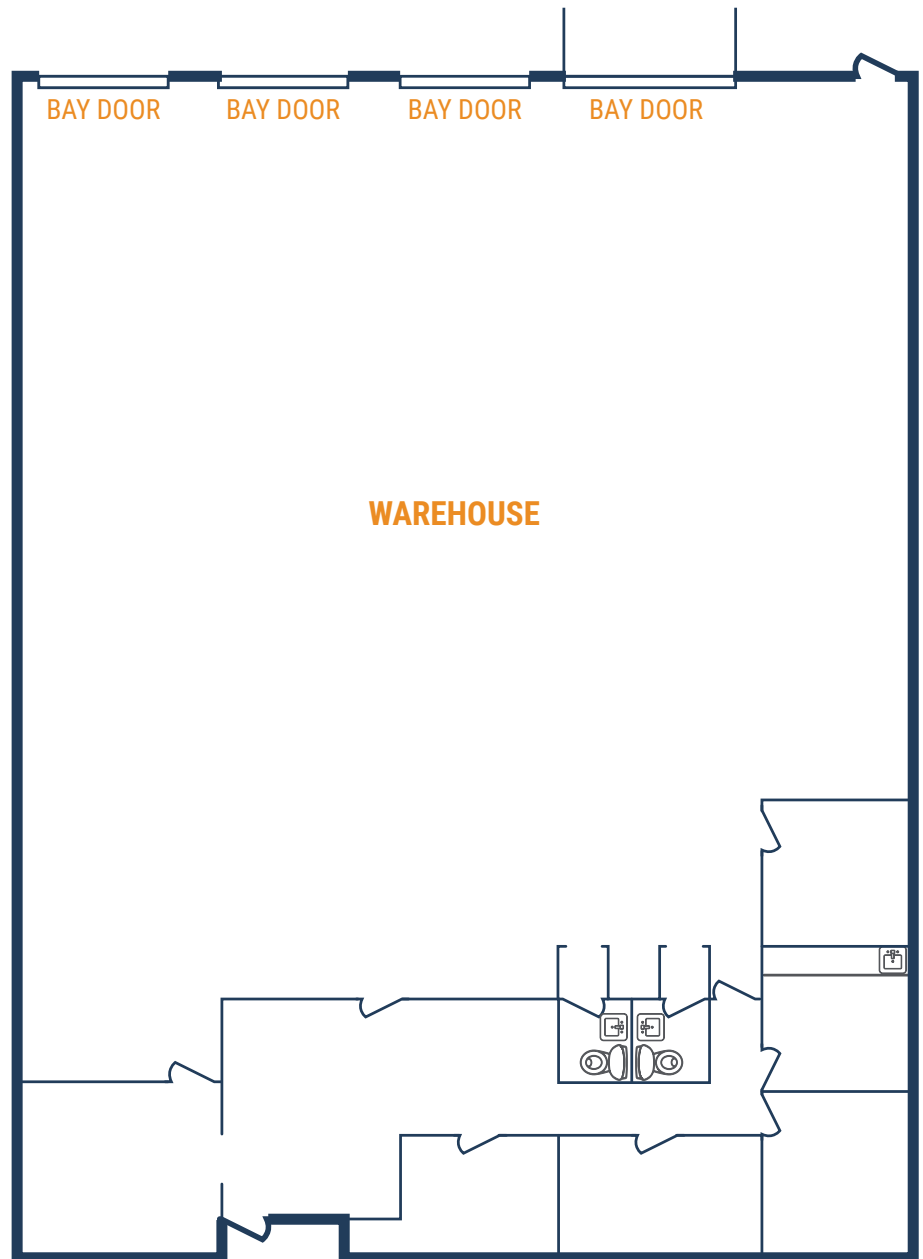

THOMAS PFEIFER



281.504.7460



THOMAS.PFEIFER@FORT-COMPANIES.COM