

SOUTHWEST BUSINESS PARK

11000 STANCLIFF ROAD & 10325 – 10415 LANDSBURY DRIVE,
HOUSTON, TX 77099



**SOUTHWEST HOUSTON/
SUGAR LAND SUBMARKET**



**GREAT ACCESS TO BELTWAY 8
AND I-69**



12' – 18' CLEAR HEIGHT



**DOCK-HIGH, SEMI-DOCK, AND
GRADE LEVEL LOADING**



FENCED YARD SPACE



2,250 SF – 15,000 SF SUITES

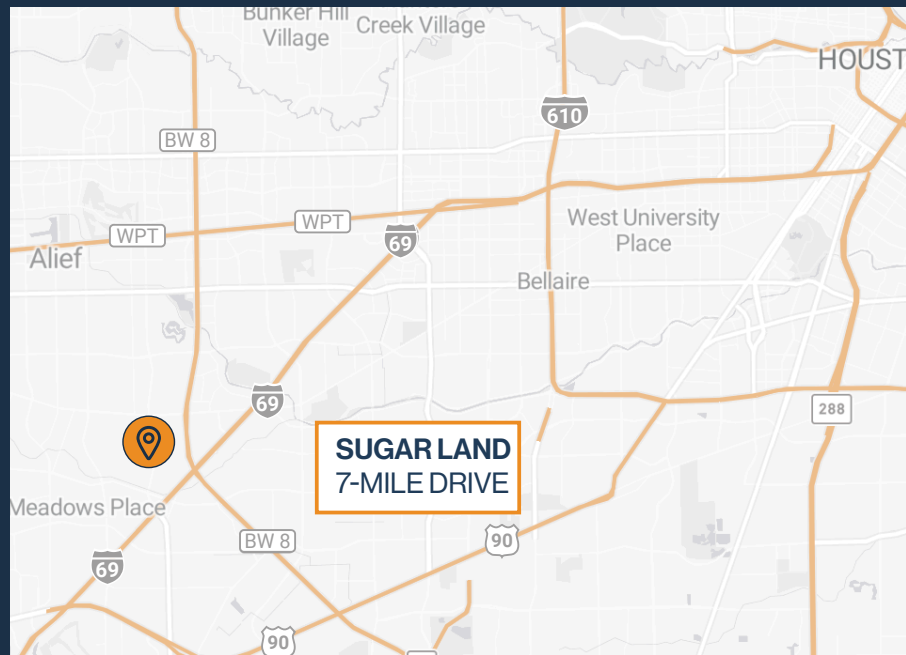

THOMAS PFEIFER



281.504.7460



THOMAS.PFEIFER@FORT-COMPANIES.COM



FORT
LEASING

This information is deemed reliable, however, Fort makes no guarantee, warranties, or representations as to the completeness or accuracy thereof.



FORT
LEASING

SOUTHWEST BUSINESS PARK

10325-10415 LANDSBURY DR, 10925, RD
STANCLIFF 11000 DR, KINGHURST
HOUSTON, TEXAS 77099

SITE PLAN

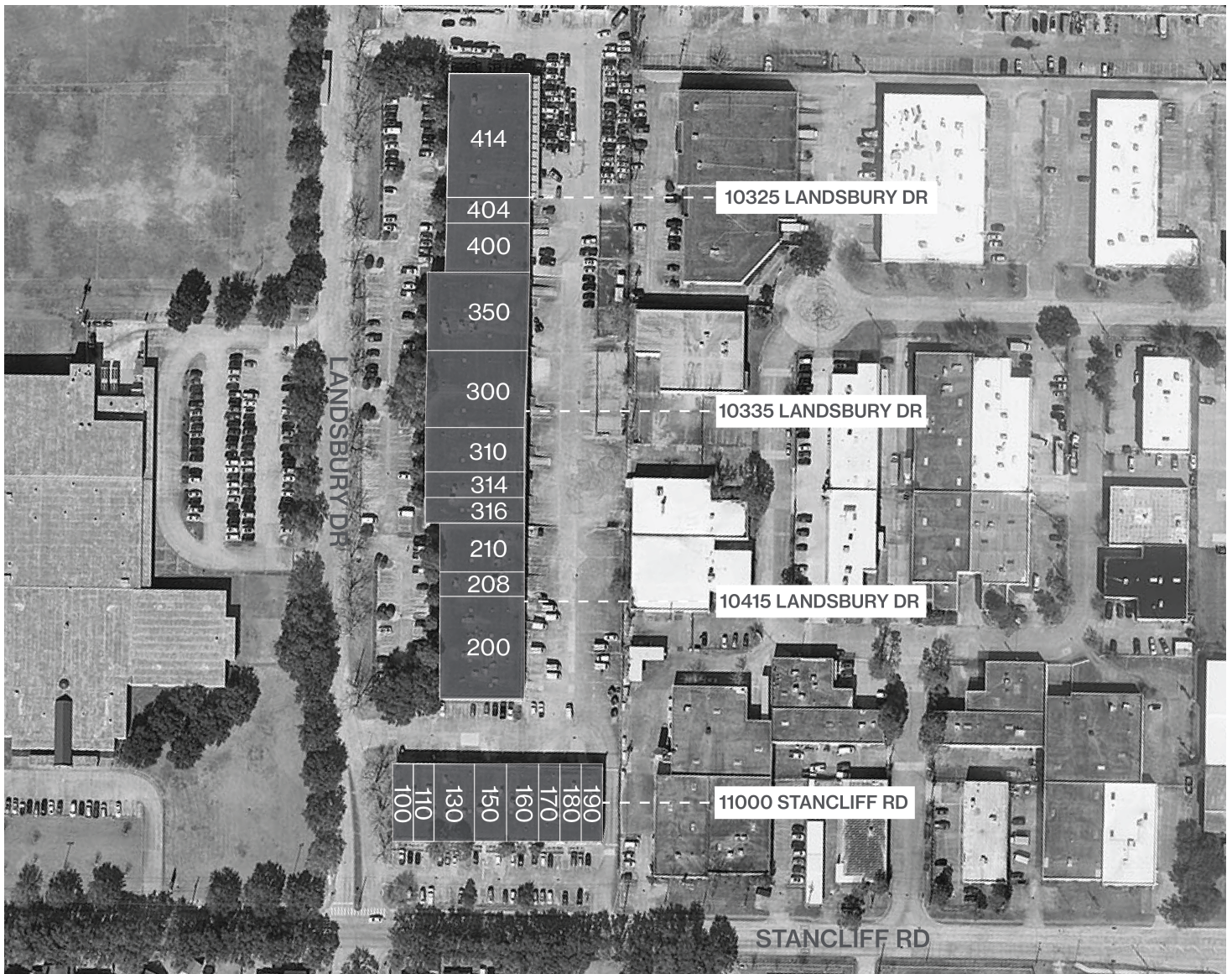

THOMAS PFEIFER

832.405.6369

thomas.pfeifer@fort-companies.com

This information is deemed reliable, however, Fort makes no guarantee, warranties, or representations as to the completeness or accuracy thereof.



FORT
LEASING

SOUTHWEST BUSINESS PARK

10325-10415 LANDSBURY DR, 11000, DR
KINGHURST 10925 RD, STANCLIFF
HOUSTON, TEXAS 77099

UNIT 310 & 314 – 10,776 SF

960 SF OFFICE / 9,816 SF WAREHOUSE

- (2) Dock High Doors
- (1) Ramp
- Partially Insulated Warehouse
- LED Warehouse lights in Suite 310

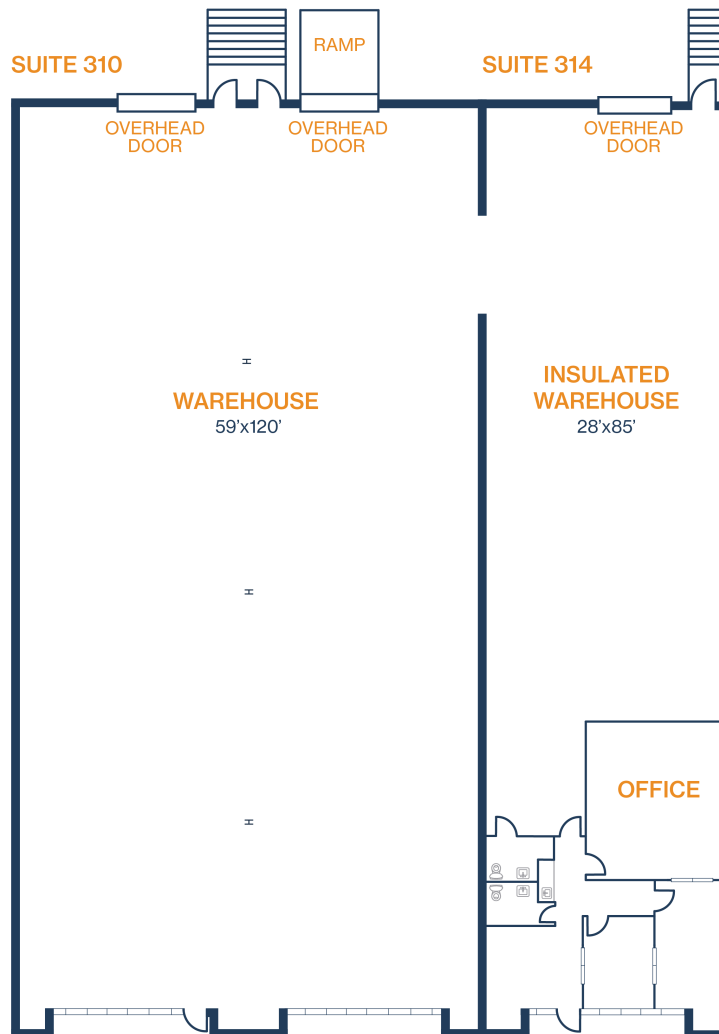

THOMAS PFEIFER

832.405.6369

thomas.pfeifer@fort-companies.com

This information is deemed reliable, however, Fort makes no guarantee, warranties, or representations as to the completeness or accuracy thereof.



FORT
LEASING

SOUTHWEST BUSINESS PARK

10325-10415 LANDSBURY DR, 11000, DR
KINGHURST 10925 RD, STANCLIFF
HOUSTON, TEXAS 77099

UNIT 316 – 3,600 SF

915 SF OFFICE / 2,685 SF WAREHOUSE

- (1) Dock High Door

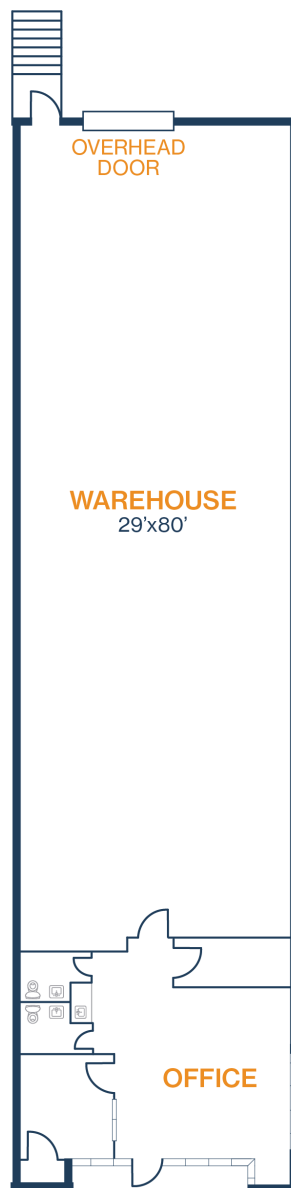

THOMAS PFEIFER

832.405.6369

thomas.pfeifer@fort-companies.com

This information is deemed reliable, however, Fort makes no guarantee, warranties, or representations as to the completeness or accuracy thereof.