

HEMPSTEAD RD INDUSTRIAL PARK

10612-10616 HEMPSTEAD RD, HOUSTON, TEXAS 77092



5,000 SF
SUITES AVAILABLE

- Northwest Outer Loop Submarket
- 14' - 20' Clear Height
- Grade-Level Loading

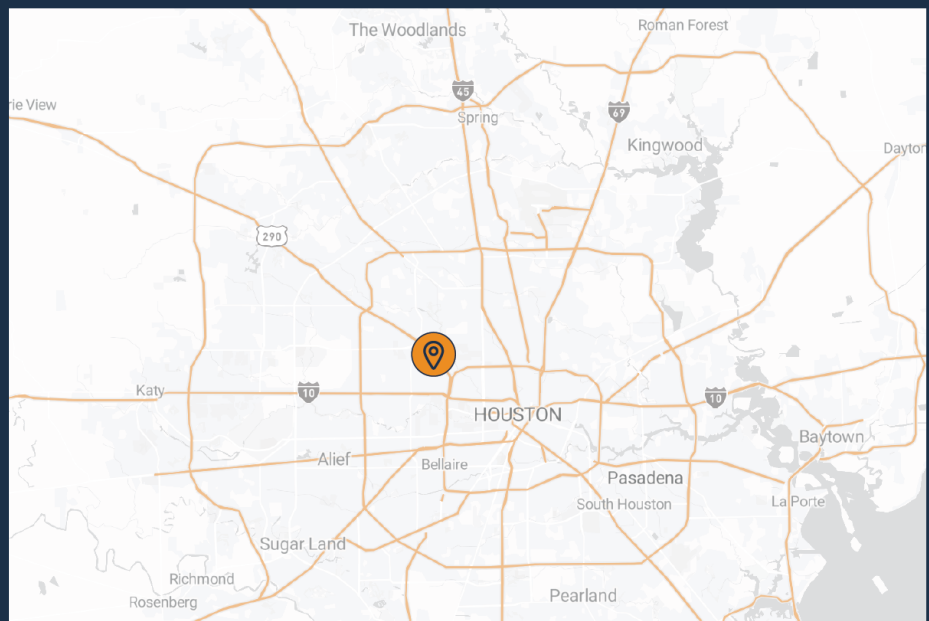

THOMAS PFEIFER

832.405.6369

thomas.pfeifer@fort-companies.com



This information is deemed reliable, however, Fort makes no guarantee, warranties, or representations as to the completeness or accuracy thereof.



FORT
LEASING

HEMPSTEAD RD INDUSTRIAL PARK

10612-10616 HEMPSTEAD RD
HOUSTON, TEXAS 77092

SITE PLAN

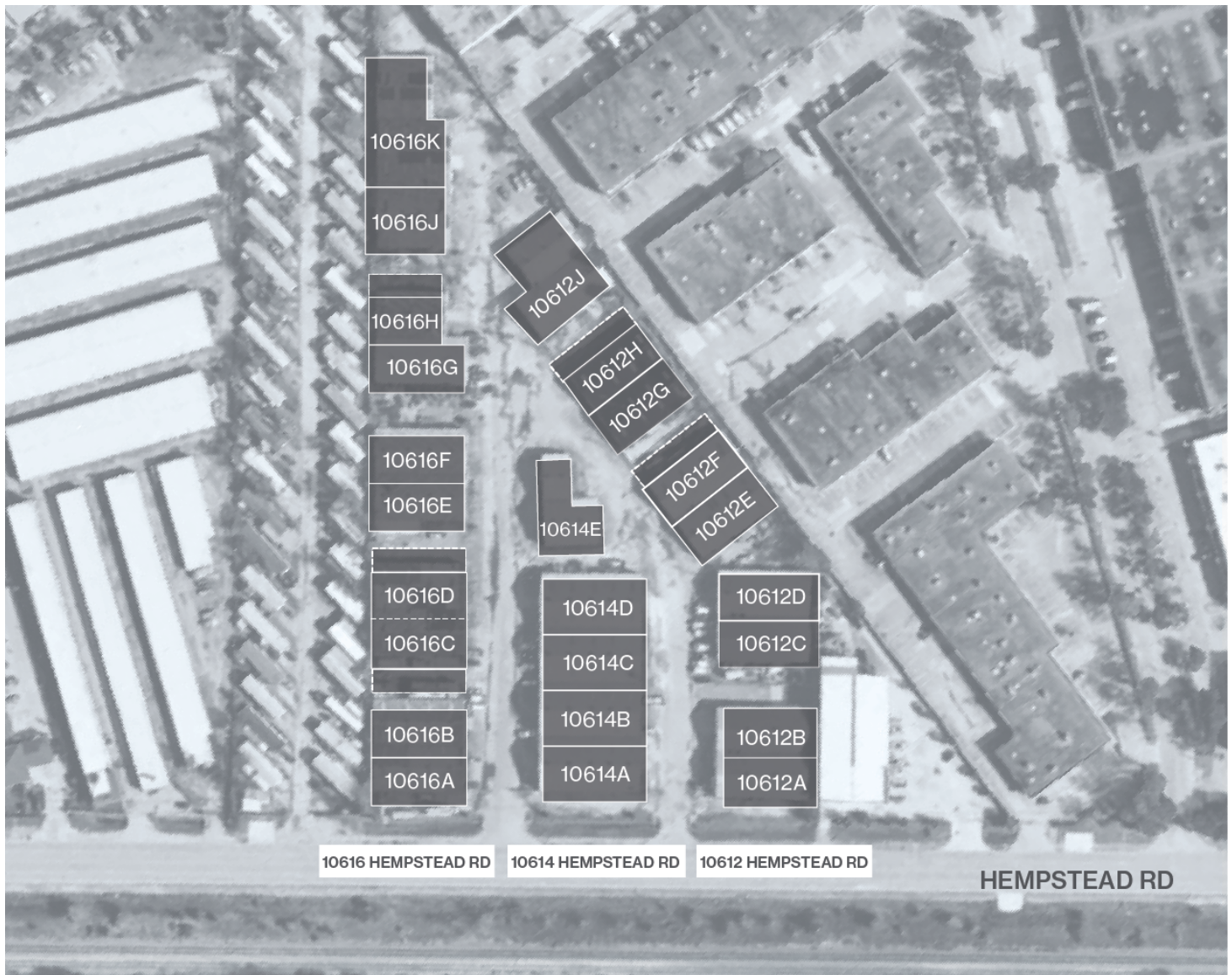

THOMAS PFEIFER
832.405.6369
thomas.pfeifer@fort-companies.com

This information is deemed reliable, however, Fort makes no guarantee, warranties, or representations as to the completeness or accuracy thereof.



FORT
LEASING

HEMPSTEAD RD INDUSTRIAL PARK

10612-10616 HEMPSTEAD RD
HOUSTON, TEXAS 77092

UNIT 612-E – 5,000 SF

1,550 SF OFFICE / 3,450 SF WAREHOUSE

- (2) Grade Level Doors
- Fenced Outside Storage
- (2) Bathrooms

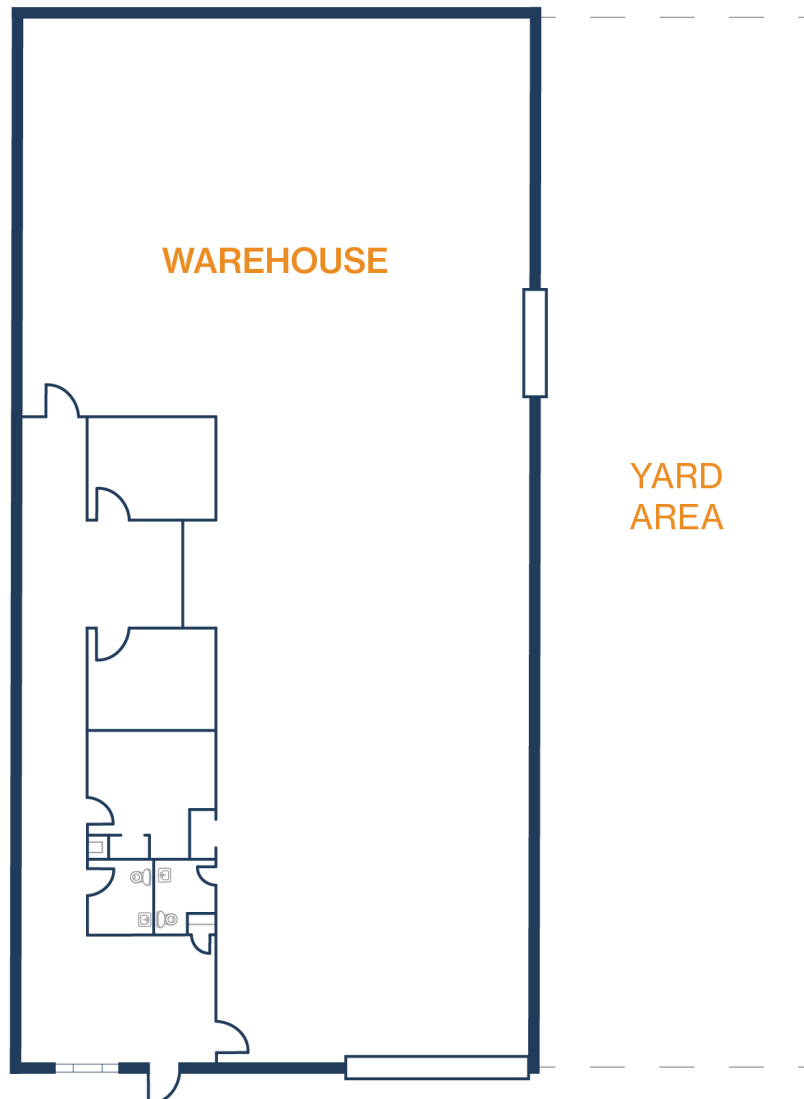

THOMAS PFEIFER

832.405.6369

thomas.pfeifer@fort-companies.com

This information is deemed reliable, however, Fort makes no guarantee, warranties, or representations as to the completeness or accuracy thereof.



FORT
LEASING

HEMPSTEAD RD INDUSTRIAL PARK

10612-10616 HEMPSTEAD RD
HOUSTON, TEXAS 77092

UNIT 612-C – 5,000 SF

850 SF OFFICE / 4,150 SF WAREHOUSE

- (2) Grade Level Doors
- Fenced Outside Storage

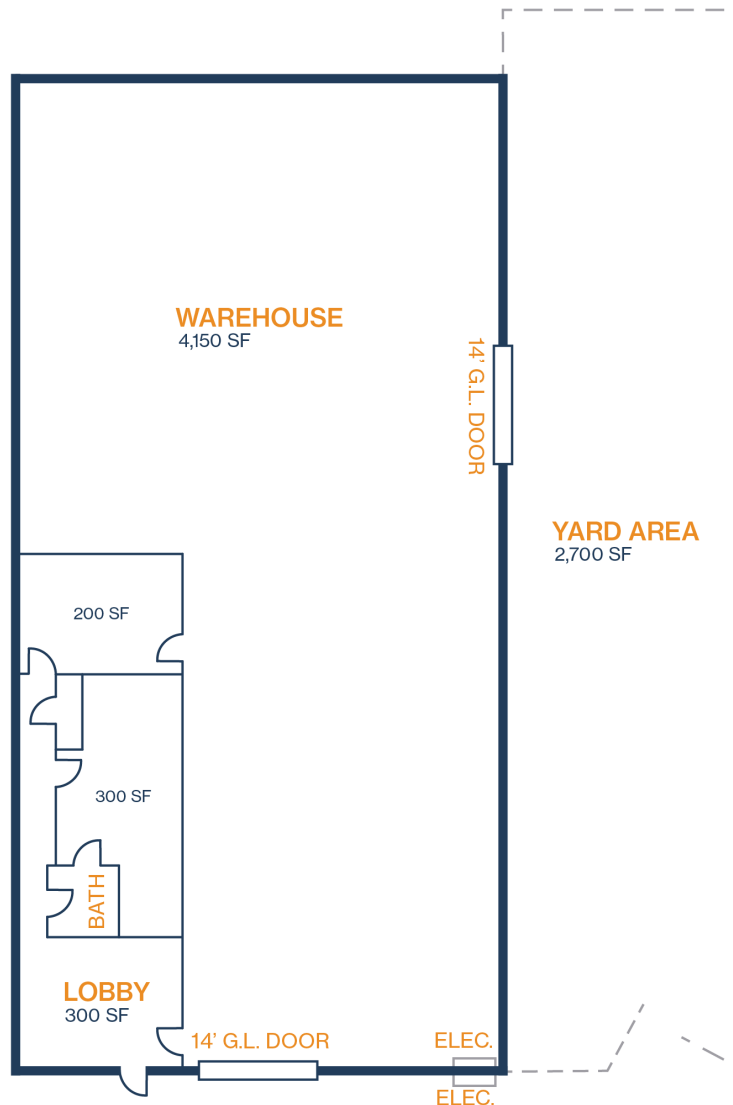

**All SF labels are approximations

THOMAS PFEIFER
832.405.6369
thomas.pfeifer@fort-companies.com

This information is deemed reliable,
however, Fort makes no guarantee,
warranties, or representations as to the
completeness or accuracy thereof.



FORT
LEASING

HEMPSTEAD RD INDUSTRIAL PARK

10612-10616 HEMPSTEAD RD
HOUSTON, TEXAS 77092

UNIT 612-D – 5,000 SF

500 SF OFFICE / 4,500 SF WAREHOUSE

- (2) Grade Level Doors

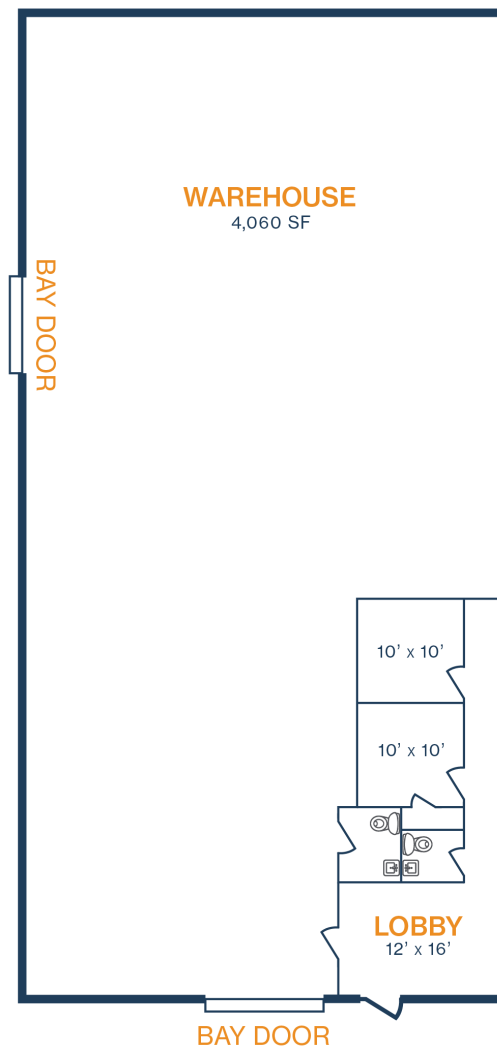

**All SF labels are approximations

THOMAS PFEIFER
832.405.6369
thomas.pfeifer@fort-companies.com

This information is deemed reliable,
however, Fort makes no guarantee,
warranties, or representations as to the
completeness or accuracy thereof.