

HEMPSTEAD 1960 BUSINESS CENTER

20220 HEMPSTEAD ROAD, HOUSTON, TX 77065



NORTHWEST SUBMARKET



GREAT ACCESS TO HWY 6/FM 1960, US-290, AND HEMPSTEAD



18'-23' CLEAR HEIGHT



TENANT-CONTROLLED HVAC



12' X 14' GRADE-LEVEL LOADING



18-WHEELER ACCESSIBLE



**1,798 SF – 9,412 SF
SUITES AVAILABLE**

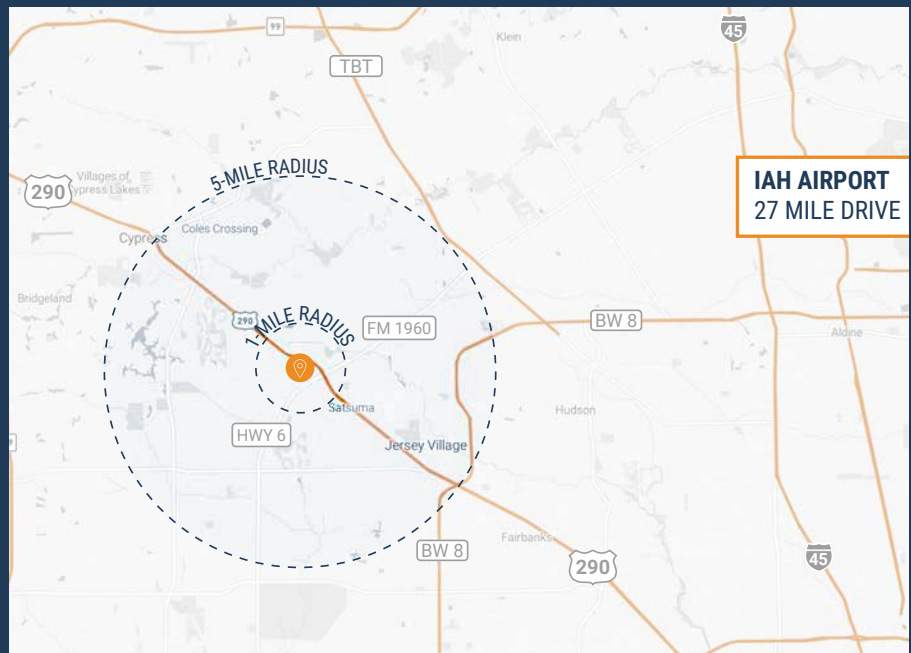

RYAN YOUNG

281.584.3320
RYAN.YOUNG@FORT-COMPANIES.COM

THOMAS PFEIFER

281.504.7460
THOMAS.PFEIFER@FORT-COMPANIES.COM



FORT CAPITAL

This information is deemed reliable, however, Fort Capital makes no guarantee, warranties, or representations as to the completeness or accuracy thereof.

SITE PLAN



RYAN YOUNG

281.584.3320
RYAN.YOUNG@FORT-COMPANIES.COM

THOMAS PFEIFER

281.504.7460
THOMAS.PFEIFER@FORT-COMPANIES.COM

This information is deemed reliable, however, Fort Capital makes no guarantee, warranties, or representations as to the completeness or accuracy thereof.

FLOOR PLAN — AVAILABLE IMMEDIATELY

- » 3,017 SF Total Available
 - » 962 SF Office
 - » 2,055 SF Warehouse
- » (1) 12' x 12' Grade Level Door

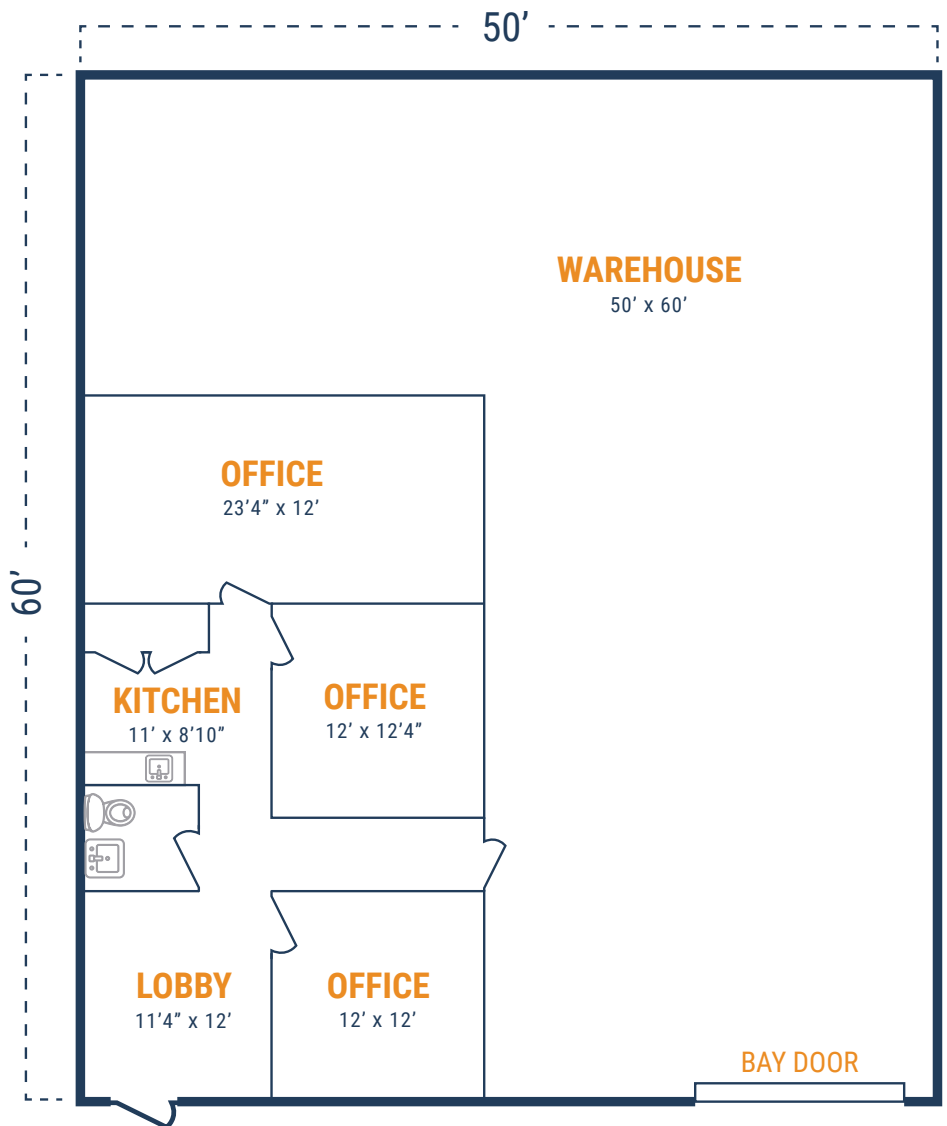

RYAN YOUNG

281.584.3320
RYAN.YOUNG@FORT-COMPANIES.COM

THOMAS PFEIFER

281.504.7460
THOMAS.PFEIFER@FORT-COMPANIES.COM

This information is deemed reliable, however, Fort Capital makes no guarantee, warranties, or representations as to the completeness or accuracy thereof.

FLOOR PLAN – AVAILABLE IMMEDIATELY

- » 2,053 SF Total Available
 - » 264 SF Office
 - » 1,789 SF Warehouse
- » (1) 12' x 12' Grade Level Door

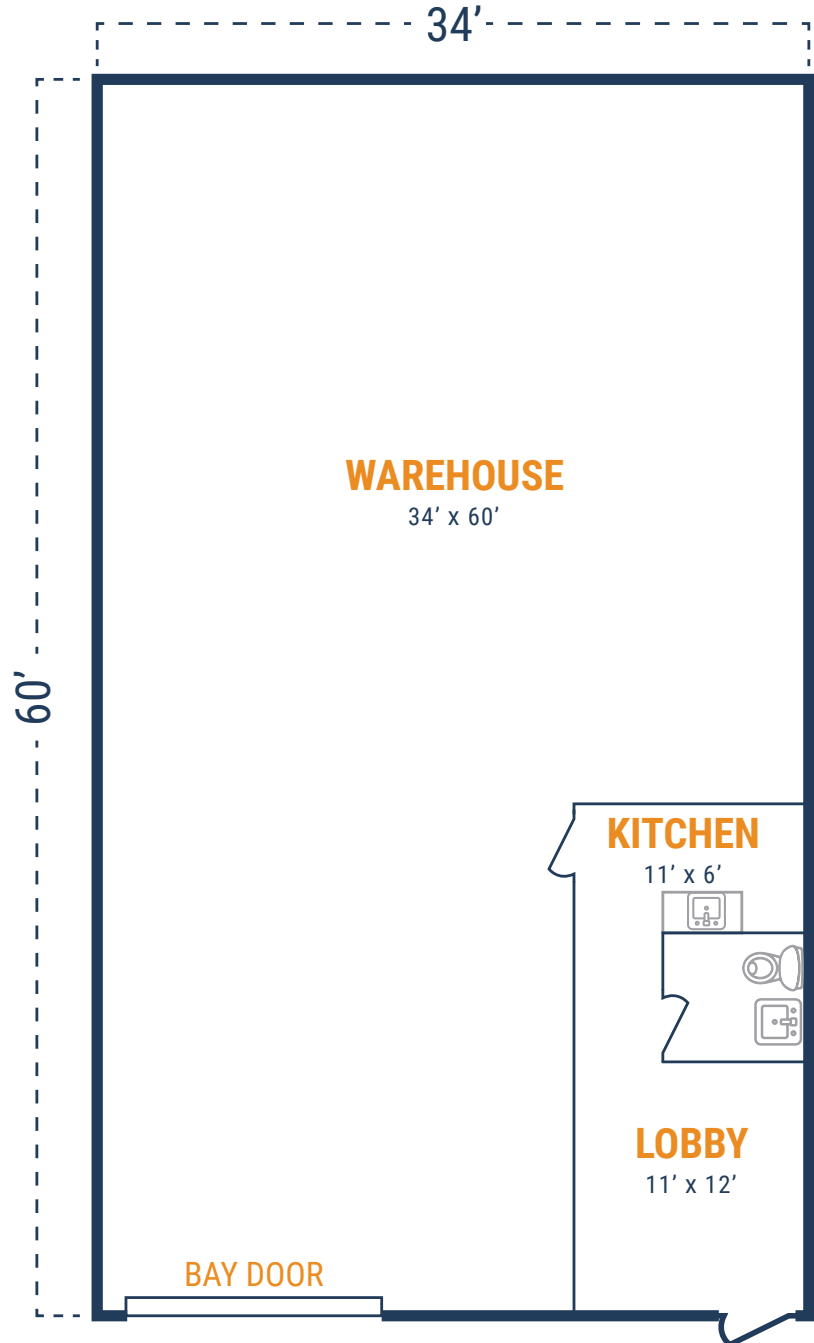

RYAN YOUNG

281.584.3320
RYAN.YOUNG@FORT-COMPANIES.COM

THOMAS PFEIFER

281.504.7460
THOMAS.PFEIFER@FORT-COMPANIES.COM

This information is deemed reliable, however, Fort Capital makes no guarantee, warranties, or representations as to the completeness or accuracy thereof.

FLOOR PLAN – AVAILABLE IMMEDIATELY

- » 3,019 SF Total Available
- » 264 SF Office
- » 2,755 SF Warehouse
- » (1) 12' x 14' Grade Level Door

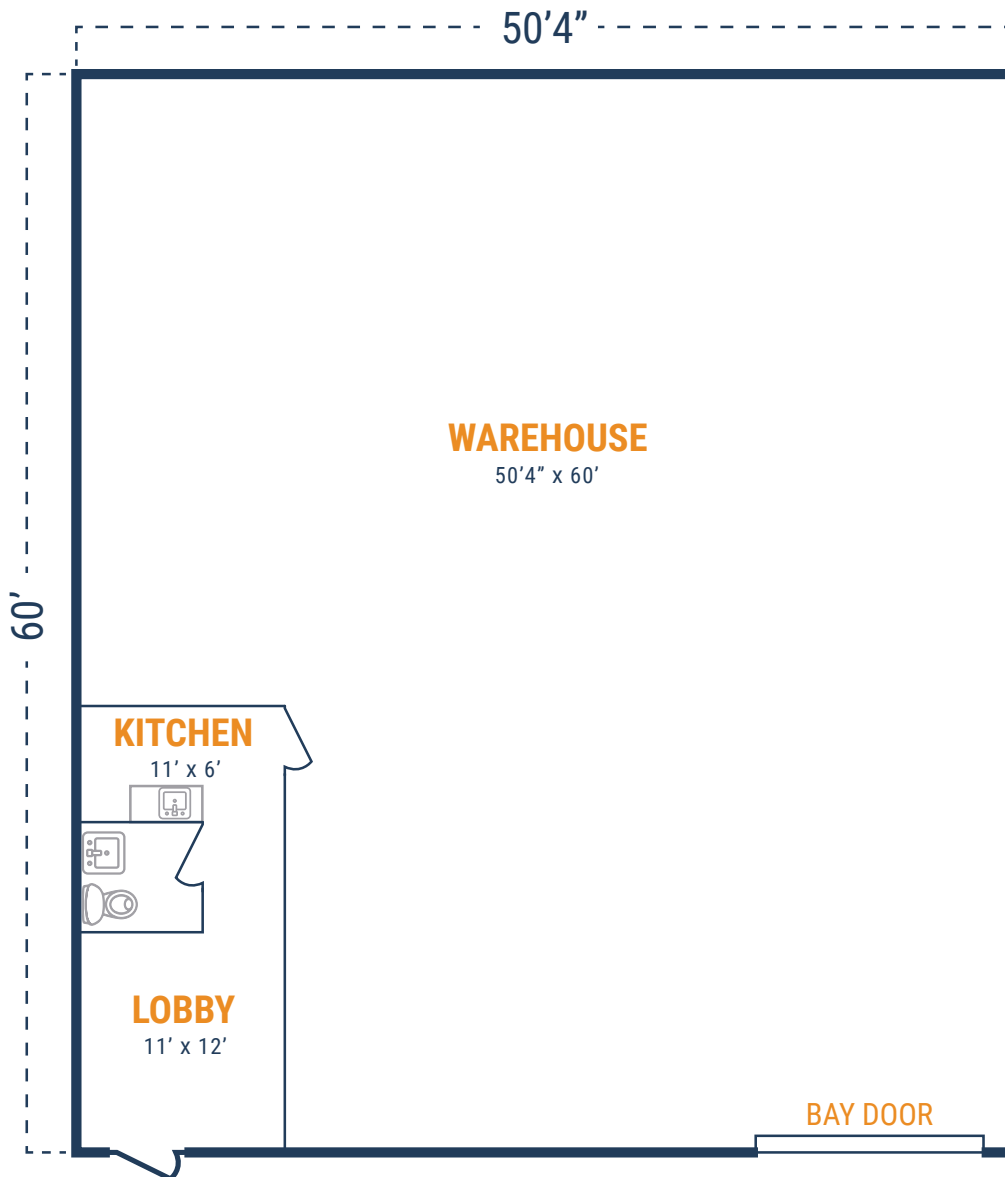

RYAN YOUNG

281.584.3320
RYAN.YOUNG@FORT-COMPANIES.COM

THOMAS PFEIFER

281.504.7460
THOMAS.PFEIFER@FORT-COMPANIES.COM

This information is deemed reliable, however, Fort Capital makes no guarantee, warranties, or representations as to the completeness or accuracy thereof.



FORT CAPITAL

HEMPSTEAD 1960 BUSINESS CENTER

20220 Hempstead Road, Suite 32 & 33
Houston, TX 77065

FLOOR PLAN – AVAILABLE IMMEDIATELY

- » 5,080 SF Total Available
- » 2,180 SF Office
- » 2,900 SF Warehouse
- » (2) 12' x 14' Grade Level Doors

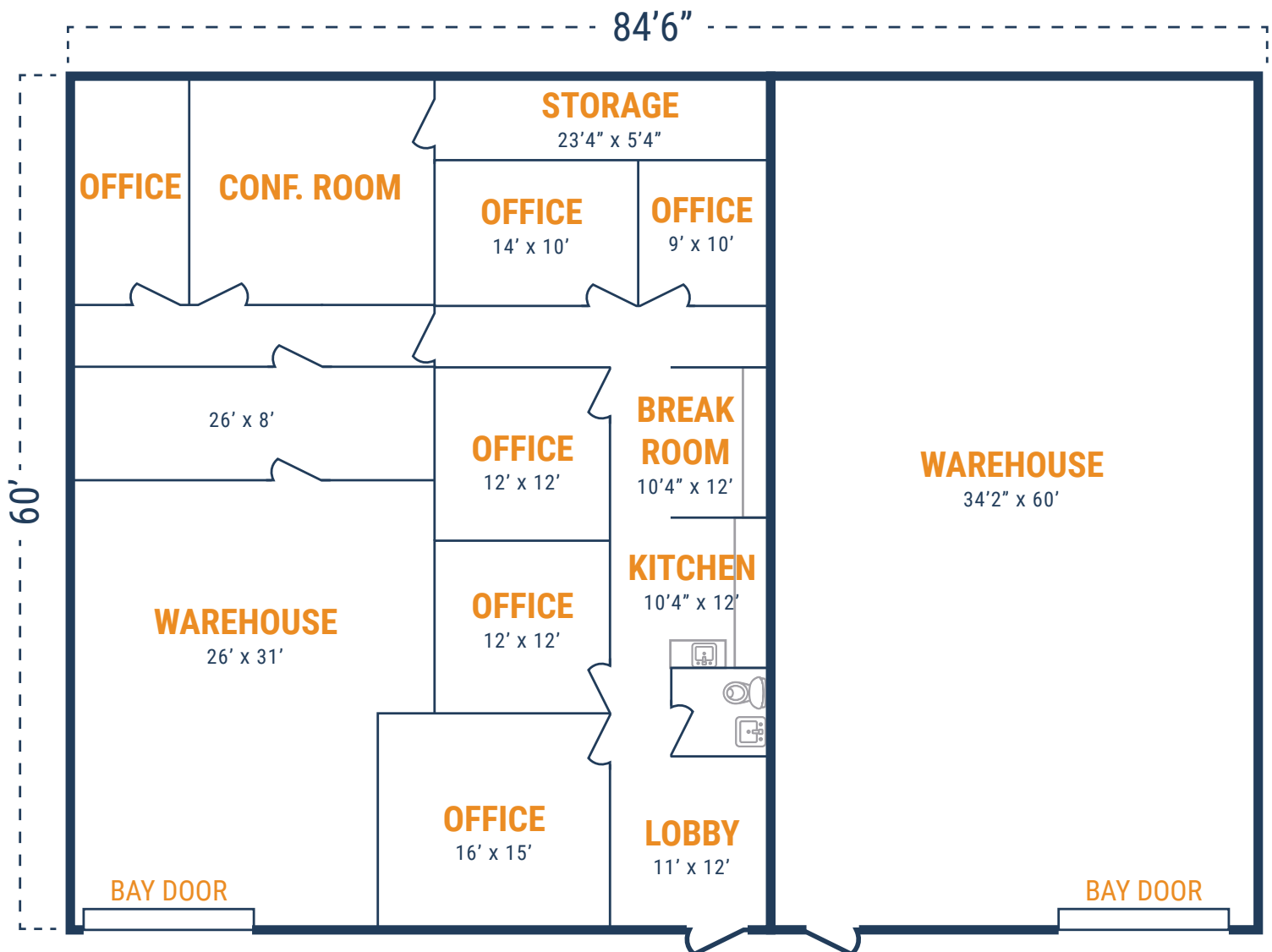

RYAN YOUNG

281.584.3320
RYAN.YOUNG@FORT-COMPANIES.COM

THOMAS PFEIFER

281.504.7460
THOMAS.PFEIFER@FORT-COMPANIES.COM

This information is deemed reliable, however, Fort Capital makes no guarantee, warranties, or representations as to the completeness or accuracy thereof.

FLOOR PLAN — AVAILABLE IMMEDIATELY

- » 2,059 SF Total Available
 - » 407 SF Office
 - » 1,652 SF Warehouse
- » (1) 12' x 14' Grade Level Door

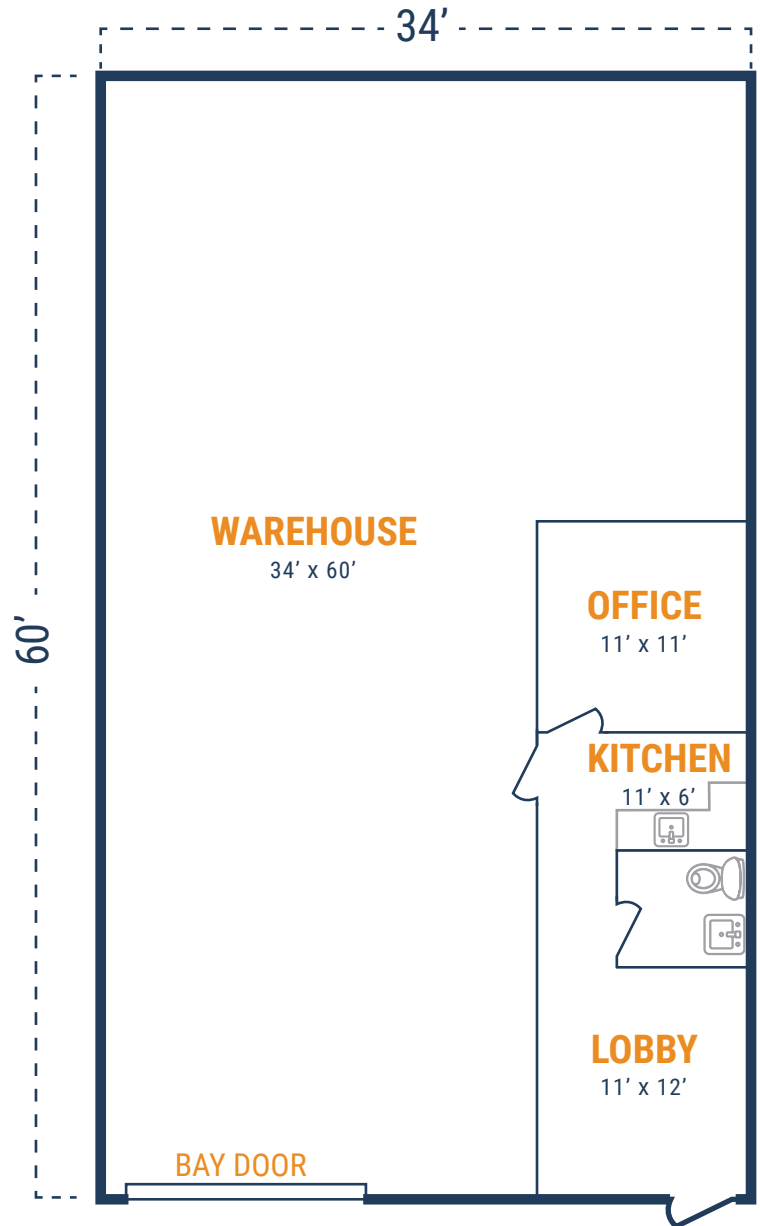

RYAN YOUNG

281.584.3320
RYAN.YOUNG@FORT-COMPANIES.COM

THOMAS PFEIFER

281.504.7460
THOMAS.PFEIFER@FORT-COMPANIES.COM

This information is deemed reliable, however, Fort Capital makes no guarantee, warranties, or representations as to the completeness or accuracy thereof.

FLOOR PLAN – AVAILABLE IMMEDIATELY

- » 7,353 SF Total Available
- » 931 SF Office
- » 6,422 SF Warehouse
- » (3) 12' x 14' Grade Level Doors

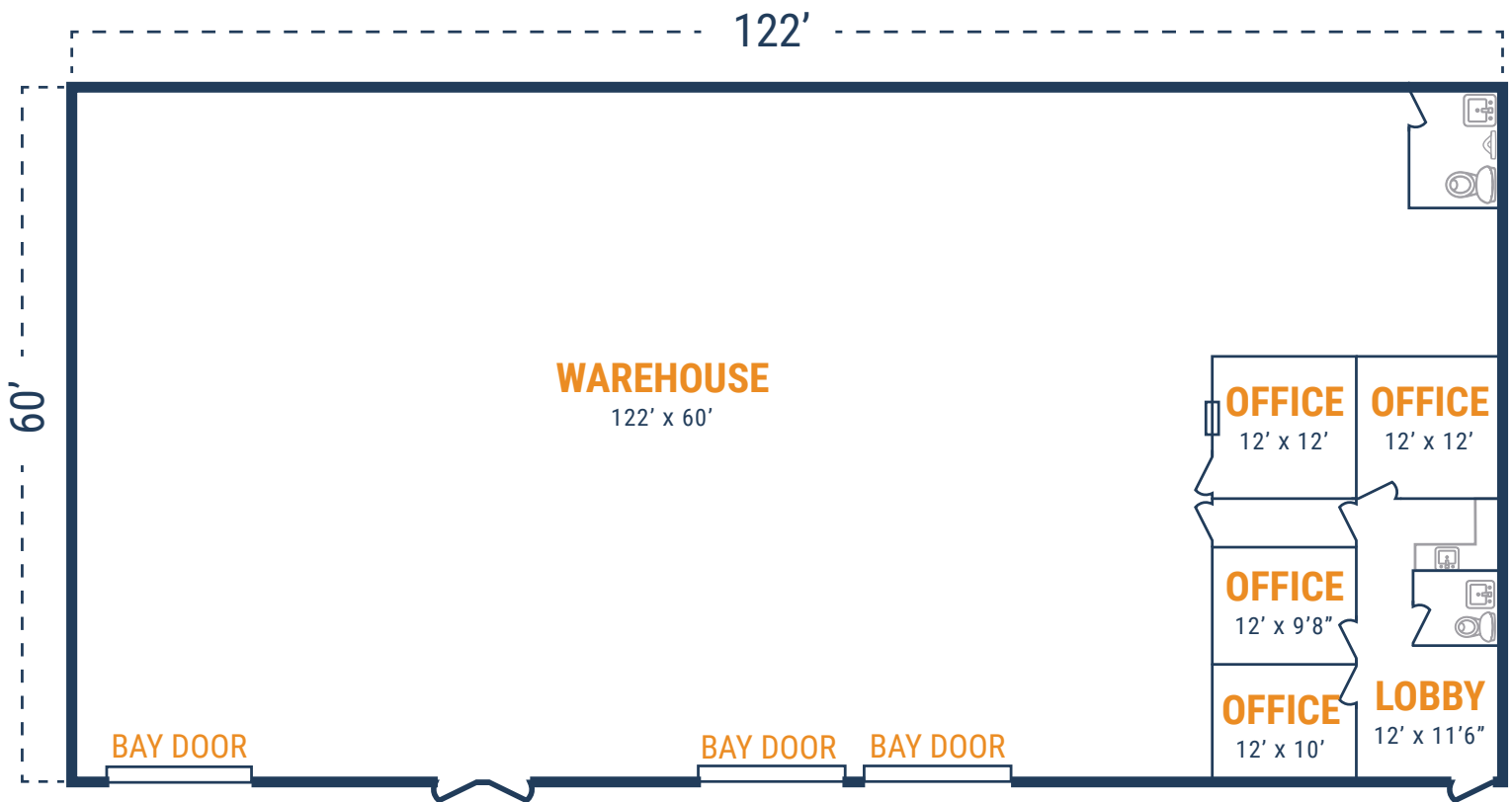

RYAN YOUNG

281.584.3320
RYAN.YOUNG@FORT-COMPANIES.COM

THOMAS PFEIFER

281.504.7460
THOMAS.PFEIFER@FORT-COMPANIES.COM

This information is deemed reliable, however, Fort Capital makes no guarantee, warranties, or representations as to the completeness or accuracy thereof.