

DAIRY ASHFORD BUSINESS PARK

12654 – 12674 GOAR ROAD, HOUSTON, TX 77077



**WEST HOUSTON/
SUGAR LAND SUBMARKET**



**GREAT ACCESS TO I-10
AND HWY-6**



16' CLEAR HEIGHT



TILT-UP CONSTRUCTION



2,310 SF SUITE AVAILABLE

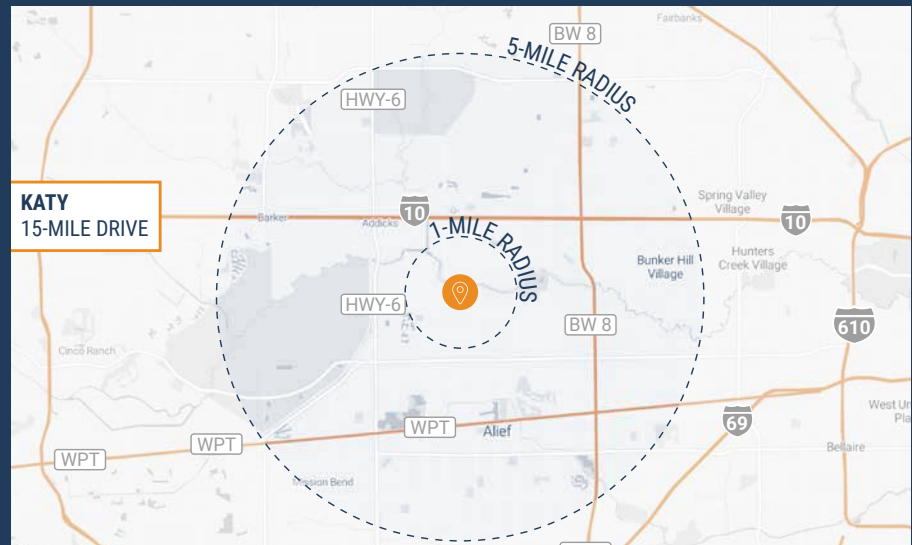

RYAN YOUNG



281.584.3320



RYAN.YOUNG@FORT-COMPANIES.COM



FORT CAPITAL

This information is deemed reliable, however, Fort Capital makes no guarantee, warranties, or representations as to the completeness or accuracy thereof.

SITE PLAN



RYAN YOUNG



281.584.3320



RYAN.YOUNG@FORT-COMPANIES.COM

This information is deemed reliable, however, Fort Capital makes no guarantee, warranties, or representations as to the completeness or accuracy thereof.

FLOOR PLAN — AVAILABLE IMMEDIATELY

- » 2,310 SF Total Available
 - » 1,612 SF Office
 - » 698 SF Warehouse

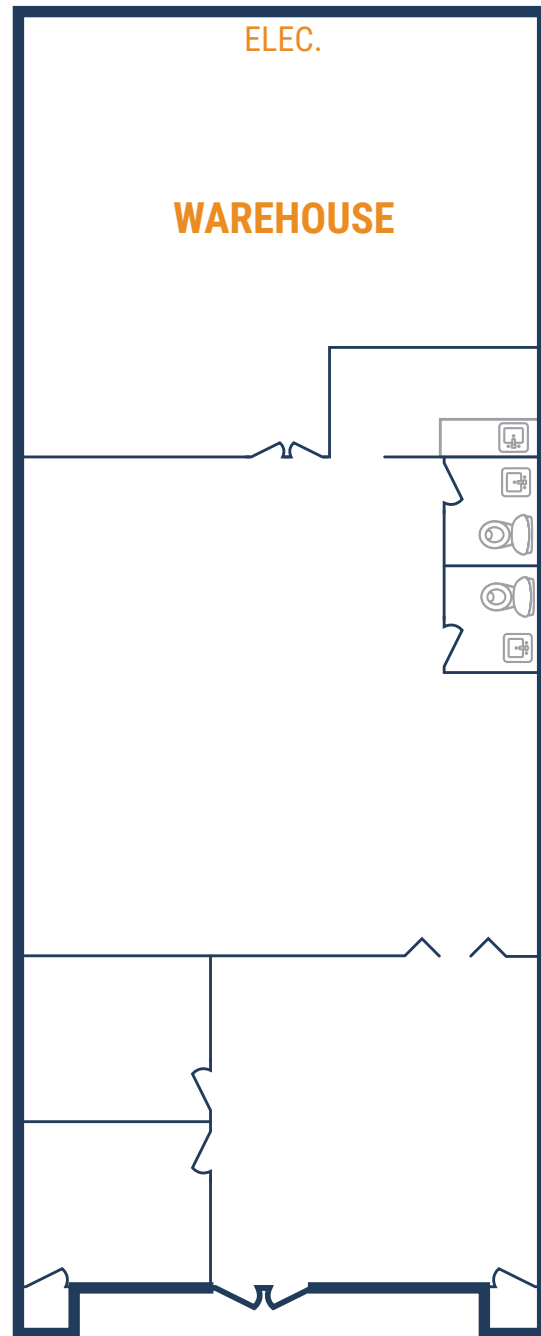

RYAN YOUNG



281.584.3320



RYAN.YOUNG@FORT-COMPANIES.COM

This information is deemed reliable, however, Fort Capital makes no guarantee, warranties, or representations as to the completeness or accuracy thereof.