

# ELDRIDGE BUSINESS CENTER

6830 N ELDRIDGE PKWY, HOUSTON, TX 77041



**NORTHWEST SUBMARKET**



**GREAT ACCESS TO BELTWAY 8,  
US-290, AND ELDRIDGE**



**24' CLEAR HEIGHT**



**CLIMATE-CONTROLLED  
WAREHOUSE**



**3-PHASE POWER**



**COMPETITIVE RATES**



**2,655 SF – 5,500 SF  
SUITES AVAILABLE**

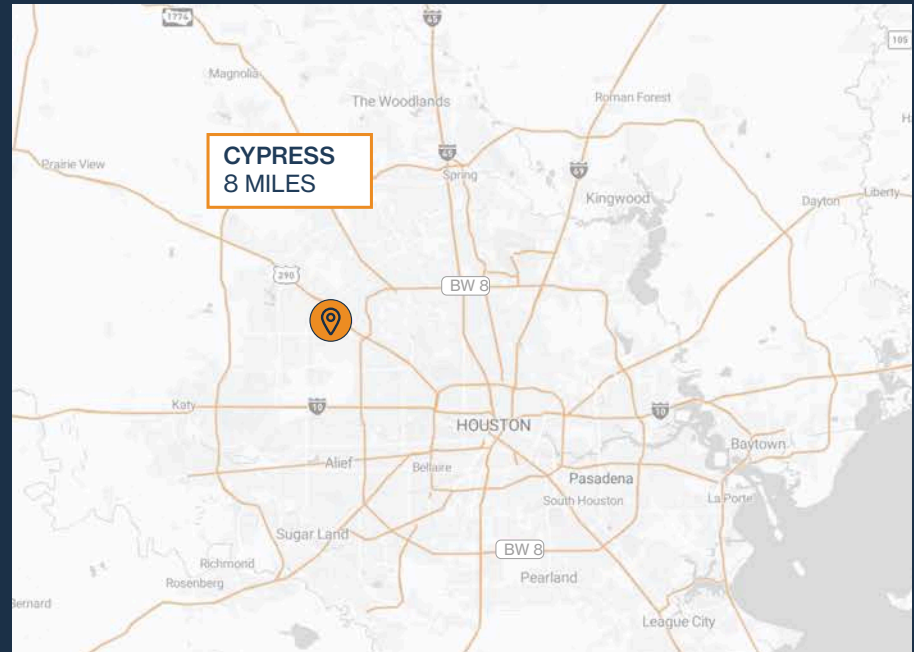

**RYAN YOUNG**



281.584.3320



RYAN.YOUNG@FORT-COMPANIES.COM



**FORT**  
LEASING

This information is deemed reliable, however, Fort makes no guarantee, warranties, or representations as to the completeness or accuracy thereof.



**FORT**  
LEASING

**ELDRIDGE BUSINESS PARK**

6830 N Eldridge Pkwy  
Houston, TX 77041

## SITE PLAN



**RYAN YOUNG**



281.584.3320

RYAN.YOUNG@FORT-COMPANIES.COM

This information is deemed reliable, however, Fort makes no guarantee, warranties, or representations as to the completeness or accuracy thereof.



## FLOOR PLAN – AVAILABLE IMMEDIATELY

- » 3,000 SF Total Available
- » 769 SF Office
- » 2,231 SF Warehouse
- » (1) Bay Door
- » Upstairs Storage

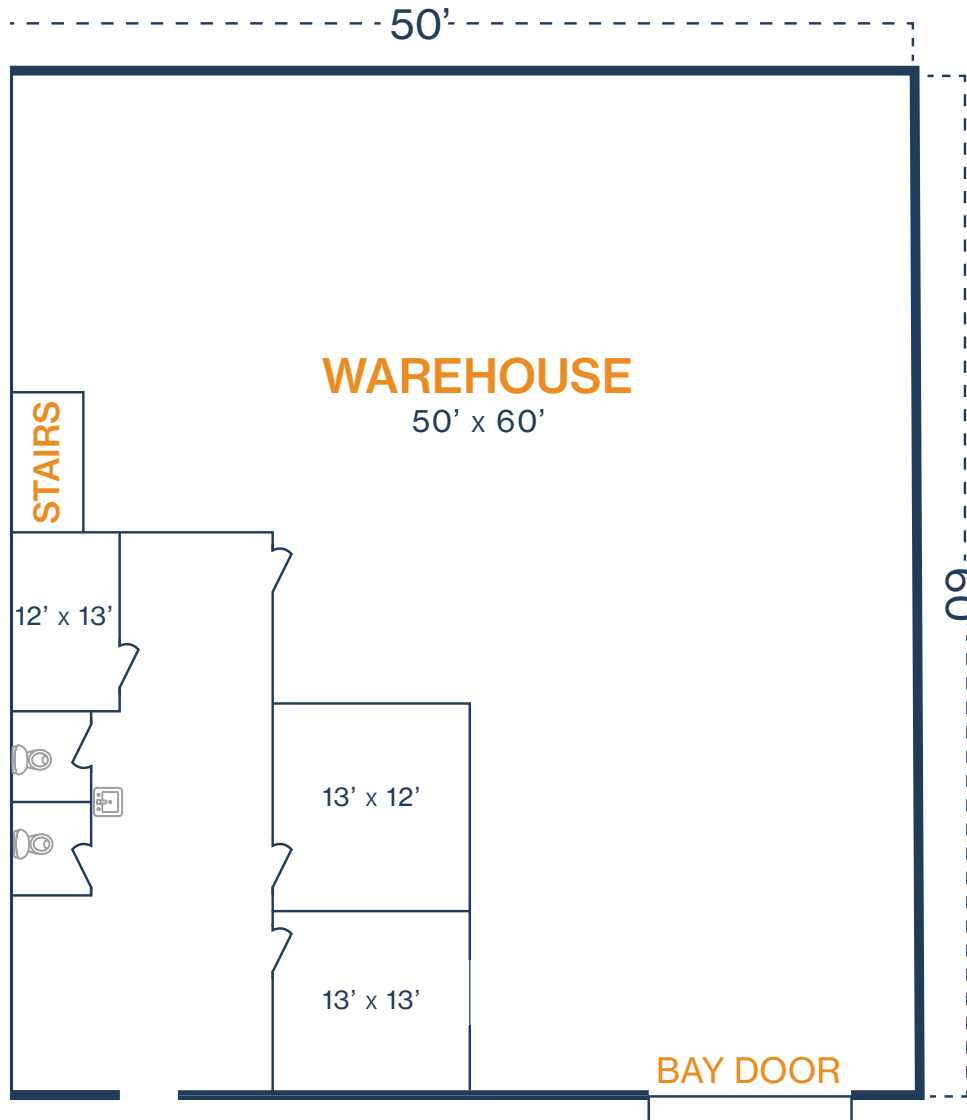

**RYAN YOUNG**



281.584.3320



RYAN.YOUNG@FORT-COMPANIES.COM



## FLOOR PLAN – AVAILABLE IMMEDIATELY

- » 2,750 SF Total Available
- » 720 SF Downstairs Office
- » 516 SF Upstairs Office
- » 2,030 SF Warehouse
- » (1) Bay Door
- » 3 Phase Power

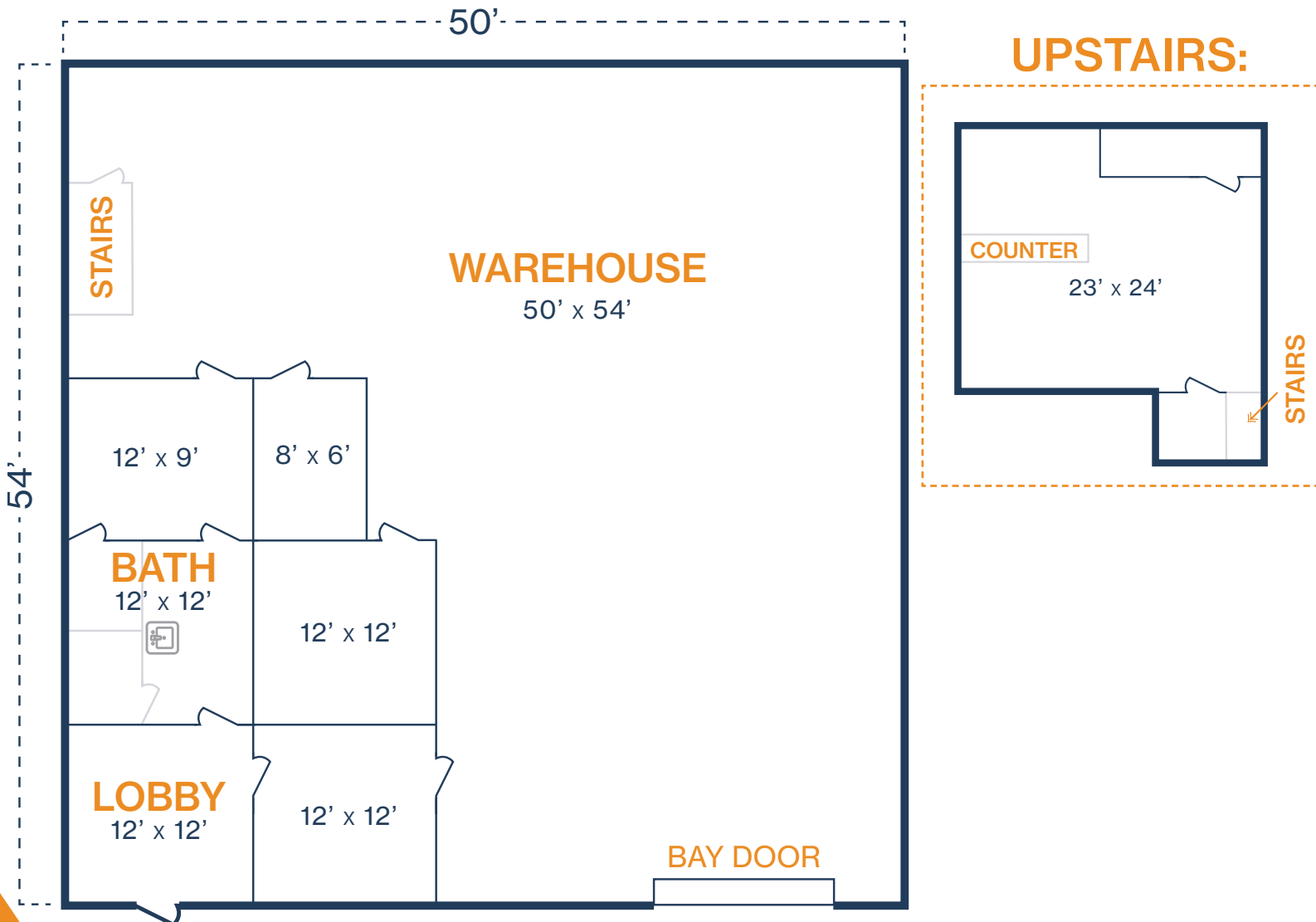

\*\*All SF labels are approximations

**RYAN YOUNG**



281.584.3320



RYAN.YOUNG@FORT-COMPANIES.COM



## FLOOR PLAN – AVAILABLE IMMEDIATELY

- » 2,750 SF Total Available
- » 432 SF Office
- » 2,318 SF Warehouse
- » (1) Bay Door
- » 3 Phase Power
- » Upstairs Storage

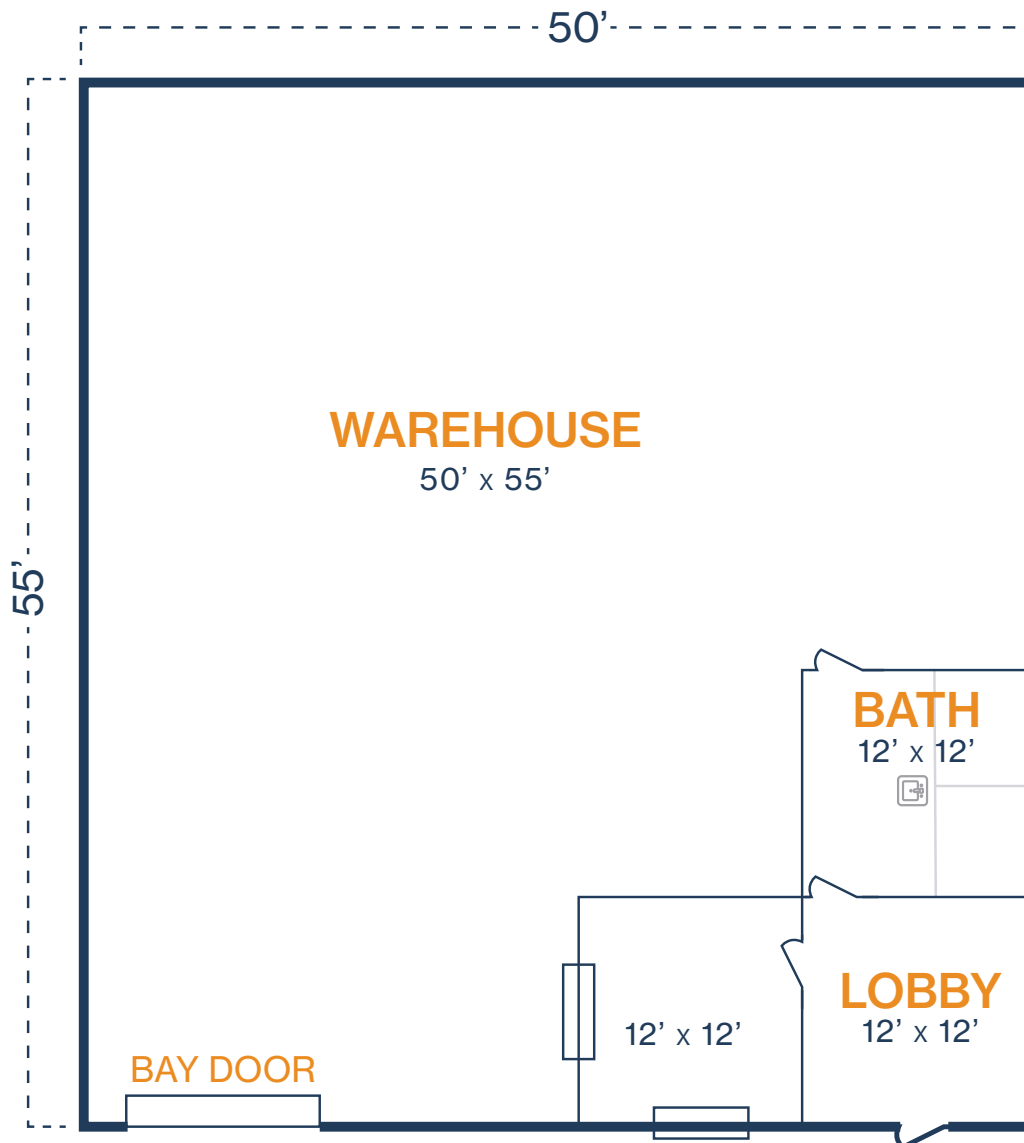

\*\*All SF labels are approximations

**RYAN YOUNG**



281.584.3320



RYAN.YOUNG@FORT-COMPANIES.COM