

CLEAR LAKE TECH CENTER

555 FORGE RIVER RD & 17146 – 17155 FEATHER CRAFT LN, WEBSTER, TX 77598



**2 MILES
FROM NASA**



**GREAT ACCESS
TO I-45**



**TILT-WALL
CONSTRUCTION**



3-PHASE POWER



**6,951 SF – 17,560 SF
SUITES AVAILABLE**

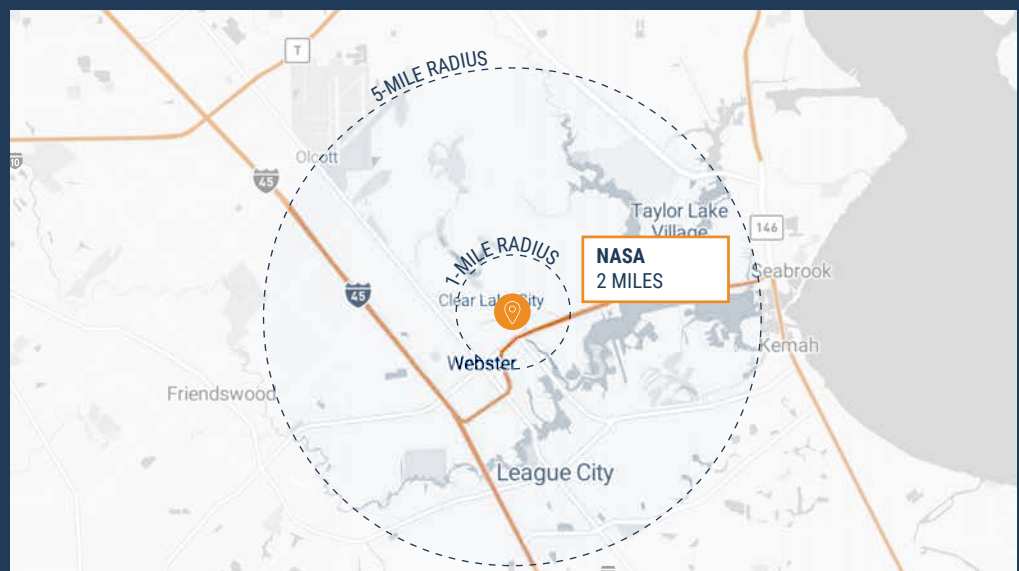

RYAN YOUNG



281.584.3320



RYAN.YOUNG@FORT-COMPANIES.COM



FORT CAPITAL

This information is deemed reliable, however, Fort Capital makes no guarantee, warranties, or representations as to the completeness or accuracy thereof.



FORT CAPITAL

CLEAR LAKE TECH CENTER

555 Forge River Rd & 17146 – 17155 Feather Craft Ln

Webster, TX 77598

SITE PLAN



RYAN YOUNG



281.584.3320



RYAN.YOUNG@FORT-COMPANIES.COM

This information is deemed reliable, however, Fort Capital makes no guarantee, warranties, or representations as to the completeness or accuracy thereof.



FORT CAPITAL

CLEAR LAKE TECH CENTER

17146 Feather Craft Lane, Unit 300

Webster, TX 77598

FLOOR PLAN – AVAILABLE IMMEDIATELY

- » 5,543 SF Total Available
- » 100% Climate Controlled



RYAN YOUNG



281.584.3320



RYAN.YOUNG@FORT-COMPANIES.COM

This information is deemed reliable, however, Fort Capital makes no guarantee, warranties, or representations as to the completeness or accuracy thereof.



FLOOR PLAN – AVAILABLE IMMEDIATELY

» 6,951 SF Total Available

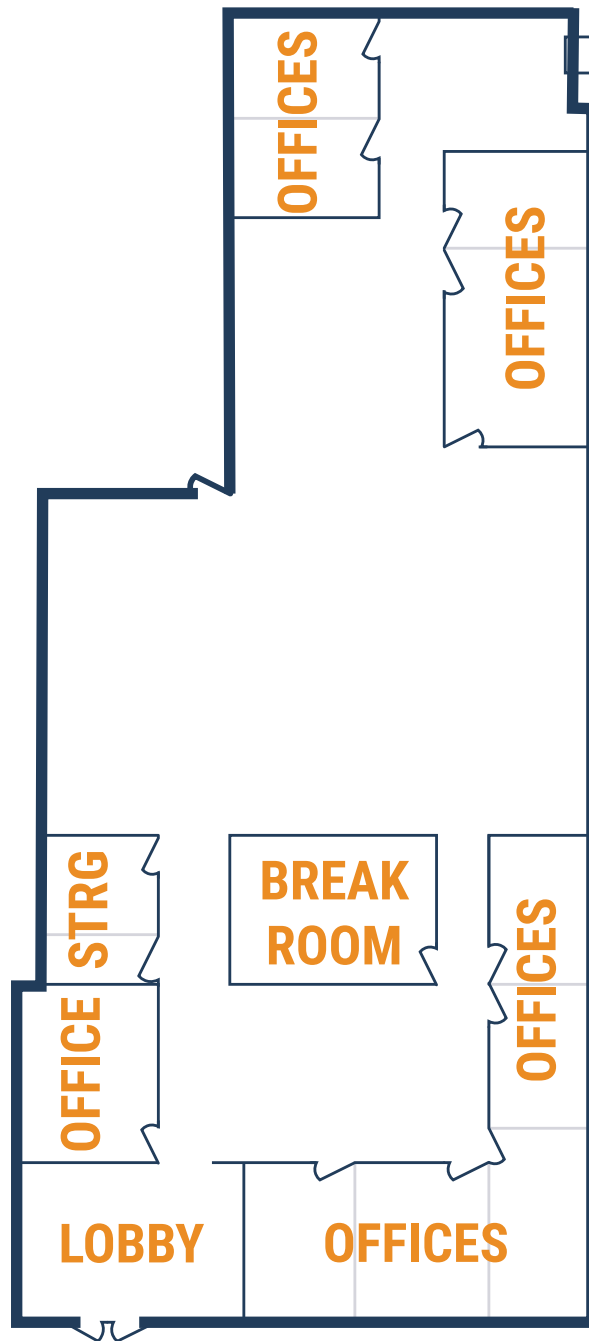

RYAN YOUNG



281.584.3320



RYAN.YOUNG@FORT-COMPANIES.COM