

CLEAR LAKE TECH CENTER

555 FORGE RIVER RD & 17146 – 17155 FEATHER CRAFT LN, WEBSTER, TX 77598



**2 MILES
FROM NASA**



**GREAT ACCESS
TO I-45**



**TILT-WALL
CONSTRUCTION**



3-PHASE POWER



**6,951 SF – 17,560 SF
SUITES AVAILABLE**

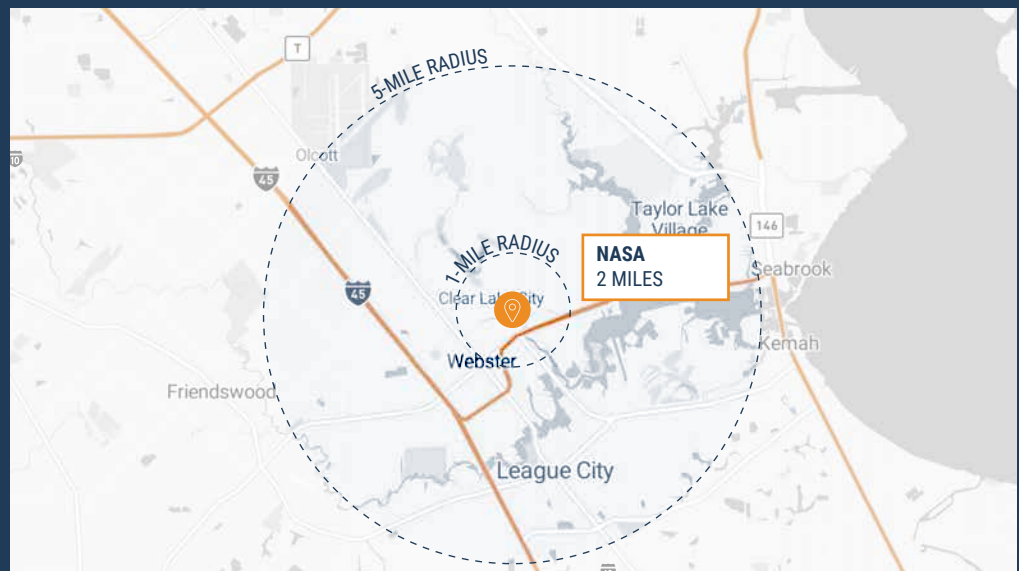

RYAN YOUNG



281.584.3320



RYAN.YOUNG@FORT-COMPANIES.COM



FORT CAPITAL

This information is deemed reliable, however, Fort Capital makes no guarantee, warranties, or representations as to the completeness or accuracy thereof.

SITE PLAN



RYAN YOUNG



281.584.3320



RYAN.YOUNG@FORT-COMPANIES.COM



FLOOR PLAN – AVAILABLE IMMEDIATELY

» 6,951 SF Total Available

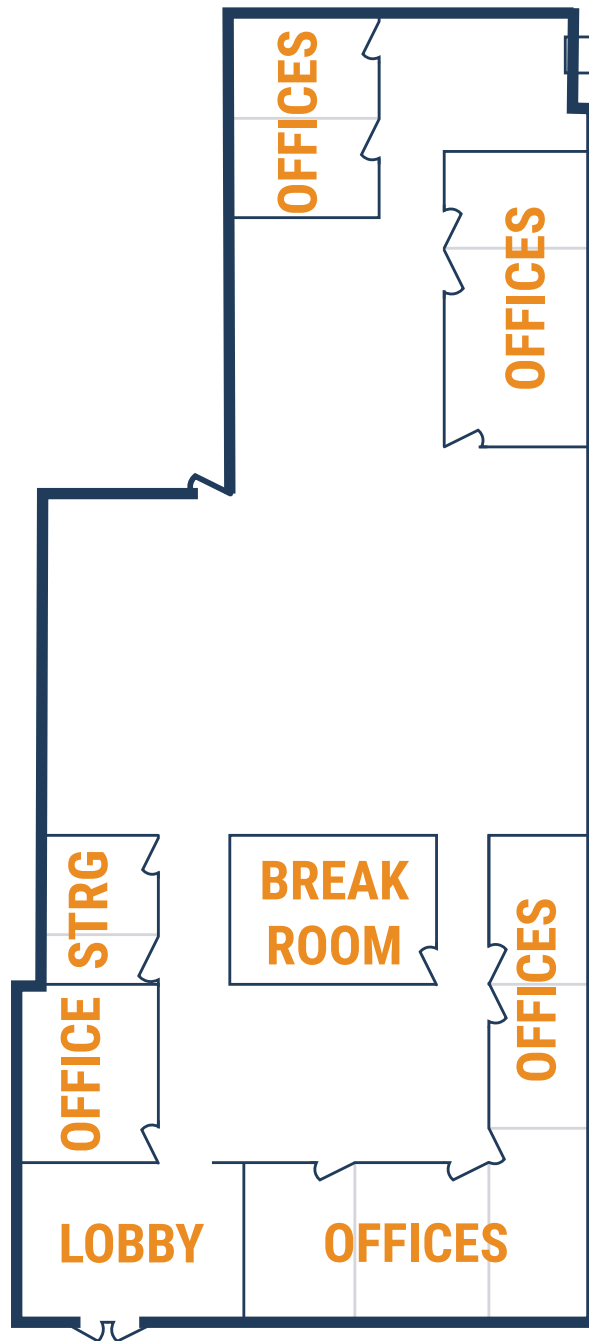

RYAN YOUNG



281.584.3320



RYAN.YOUNG@FORT-COMPANIES.COM



FLOOR PLAN – AVAILABLE FEBRUARY 2024

» 17,560 SF Total Available

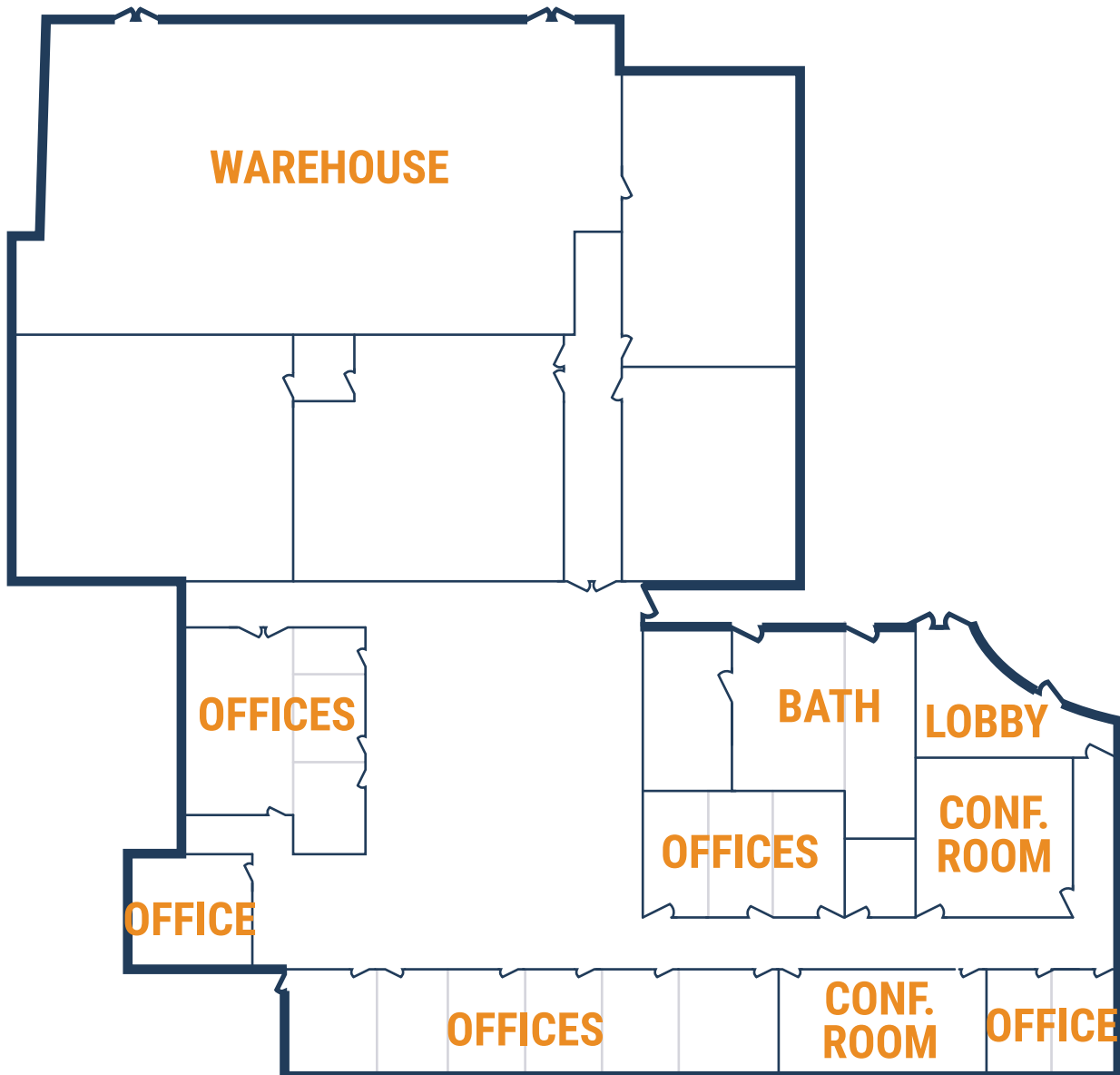

RYAN YOUNG



281.584.3320



RYAN.YOUNG@FORT-COMPANIES.COM



FLOOR PLAN – AVAILABLE FEBRUARY 2024

» 11,938 SF Total Available

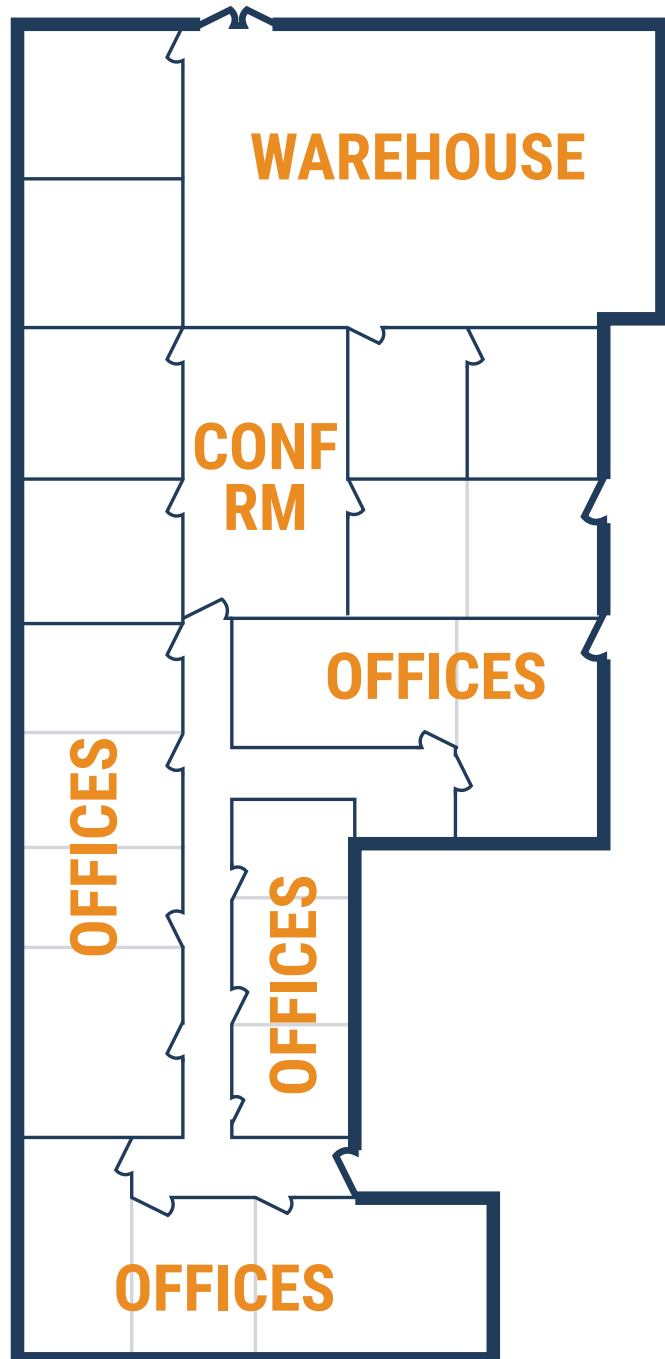

RYAN YOUNG



281.584.3320



RYAN.YOUNG@FORT-COMPANIES.COM