

BROOKLET BUSINESS CENTER

11011 BROOKLET DRIVE, HOUSTON, TX 77099



**SOUTHWEST HOUSTON/
SUGAR LAND SUBMARKET**



**GREAT ACCESS TO I-69
AND BELTWAY-8**



14' AVERAGE CLEAR HEIGHT



TENANT-CONTROLLED HVAC



**GRADE-LEVEL AND
SEMI-DOCK LOADING**



DRIVE-UP SURFACE PARKING



**2,055 SF - 16,379 SF
SUITES AVAILABLE**

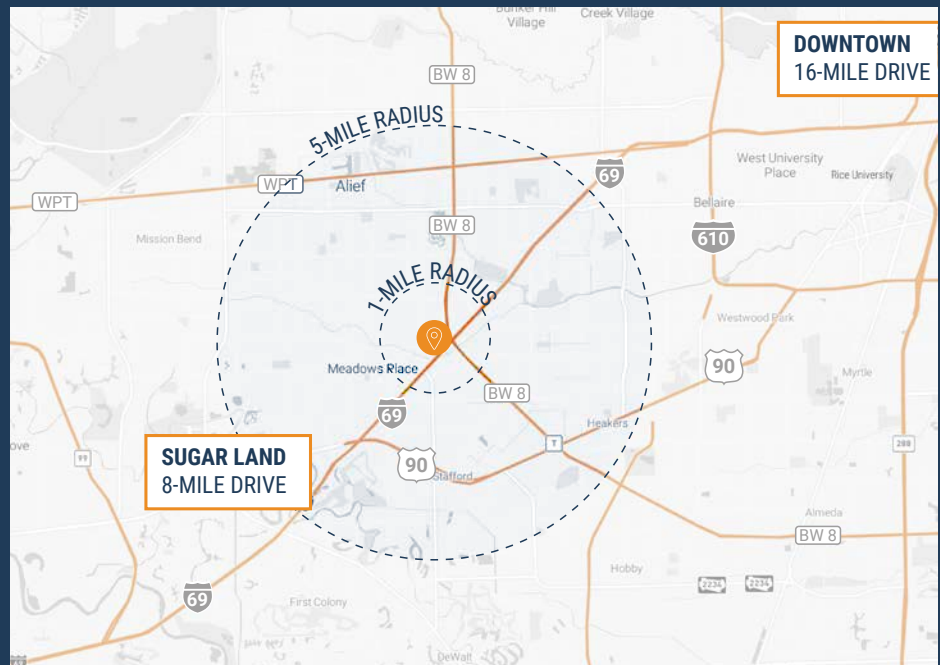

**DOWNTOWN
16-MILE DRIVE**

**SUGAR LAND
8-MILE DRIVE**

THOMAS PFEIFER



281.504.7460



THOMAS.PFEIFER@FORT-COMPANIES.COM



FORT CAPITAL

This information is deemed reliable, however, Fort Capital makes no guarantee, warranties, or representations as to the completeness or accuracy thereof.



FORT CAPITAL

BROOKLET BUSINESS CENTER

11011 Brooklet Drive
Houston, TX 77099

SITE PLAN

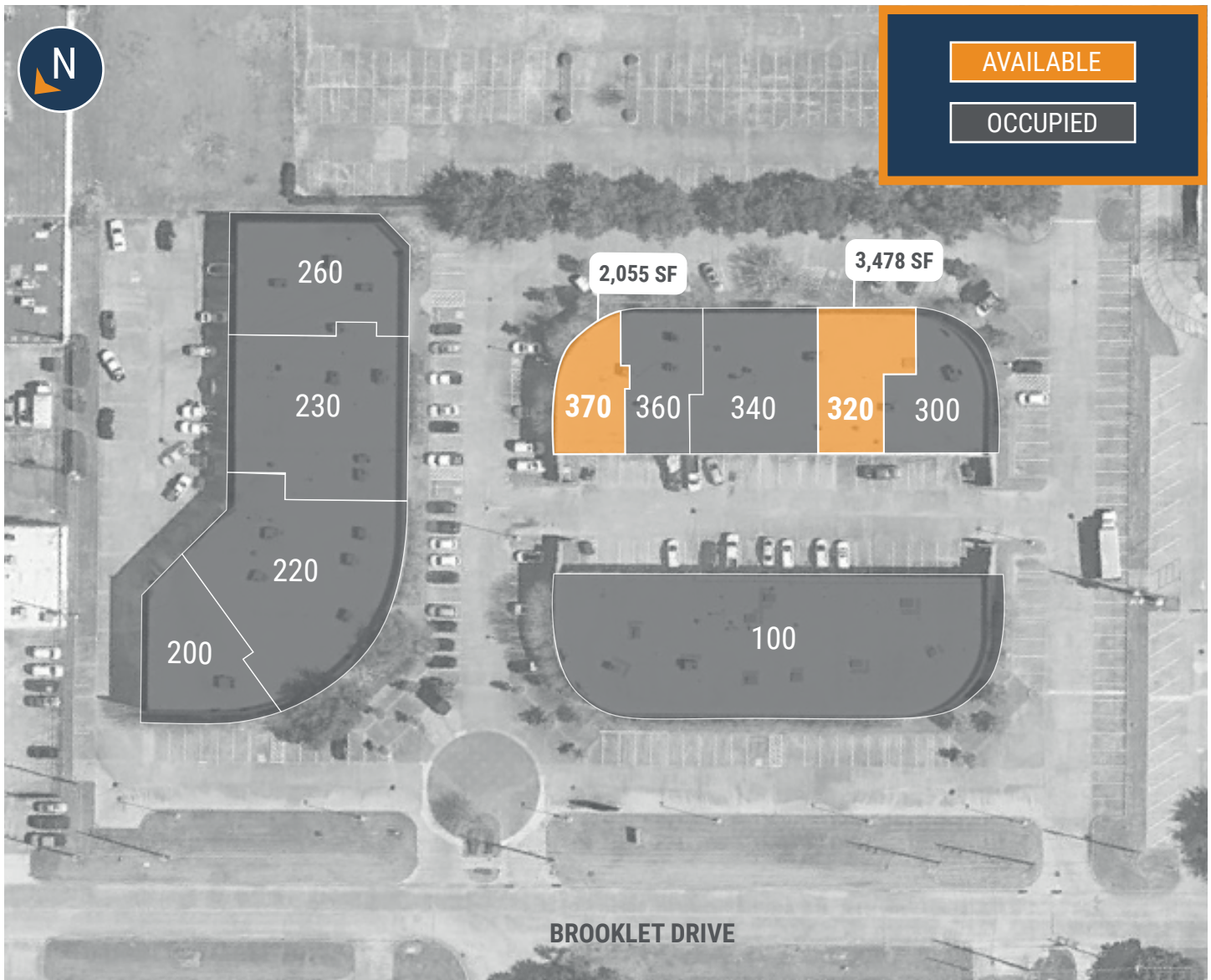

THOMAS PFEIFER



281.504.7460



THOMAS.PFEIFER@FORT-COMPANIES.COM

This information is deemed reliable, however, Fort Capital makes no guarantee, warranties, or representations as to the completeness or accuracy thereof.



FLOOR PLAN – AVAILABLE IMMEDIATELY

- » 3,478 SF Total Available
- » 3,035 SF Office
- » 443 SF Warehouse
- » (1) 10' x 10' Grade-Level Door



THOMAS PFEIFER



281.504.7460



THOMAS.PFEIFER@FORT-COMPANIES.COM



FLOOR PLAN – AVAILABLE DECEMBER 2023

- » 2,055 SF Total Available
- » 1,780 SF Office
- » 275 SF Warehouse
- » (1) 10' x 10' Grade-Level Door

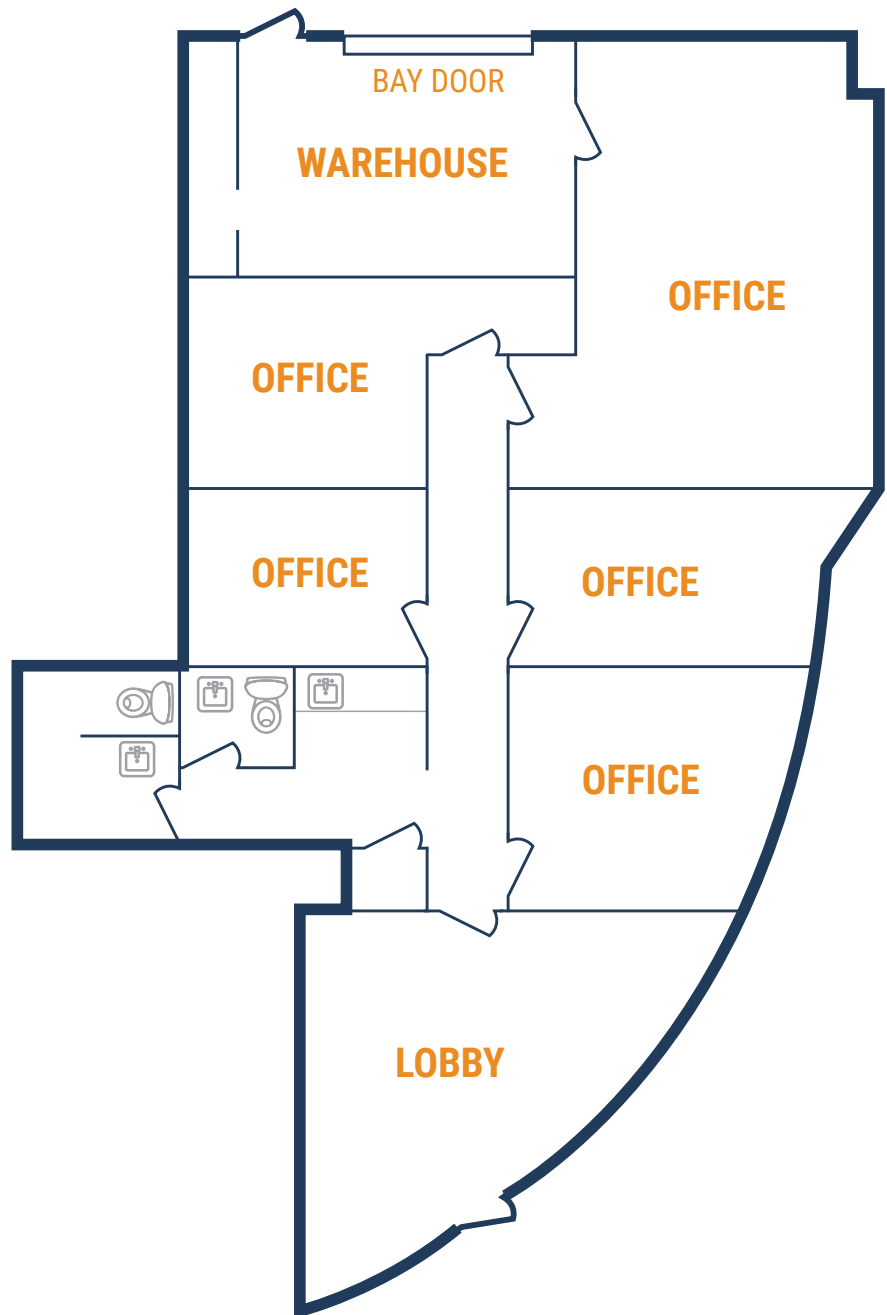

THOMAS PFEIFER



281.504.7460



THOMAS.PFEIFER@FORT-COMPANIES.COM