

STONECREST BUSINESS CENTER

11000 WILCREST DR. & 10804-10816 FALLSTONE RD., HOUSTON, TX 77099



**SOUTHWEST HOUSTON &
SUGARLAND SUBMARKET**



**GREAT ACCESS TO I-69
AND BELTWAY 8**



**100% CLIMATE-CONTROLLED
SUITES AVAILABLE**



**GRADE-LEVEL, SEMI-DOCK,
AND DOCK-HIGH LOADING**



DRIVE-UP SURFACE PARKING



**1,570 SF - 12,230 SF
SUITES AVAILABLE**

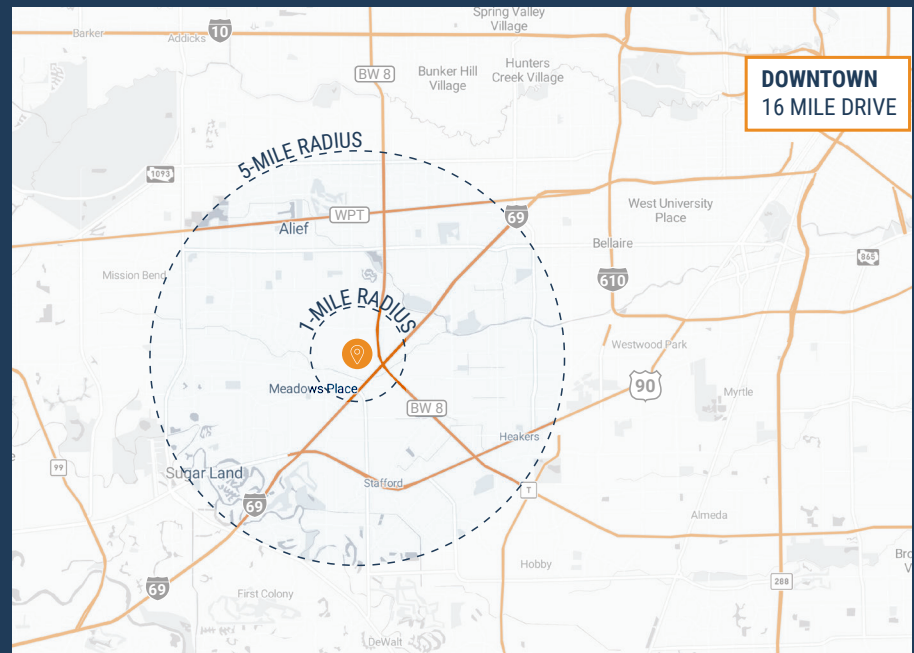

THOMAS PFEIFER



281.504.7460



THOMAS.PFEIFER@FORT-COMPANIES.COM



FORT CAPITAL

This information is deemed reliable, however, Fort Capital makes no guarantee, warranties, or representations as to the completeness or accuracy thereof.



FORT CAPITAL

STONECREST BUSINESS CENTER

11000 Wilcrest Dr. & 10804-10816 Fallstone Rd.
Houston, TX 77099

SITE PLAN



THOMAS PFEIFER



281.504.7460

THOMAS.PFEIFER@FORT-COMPANIES.COM

This information is deemed reliable, however, Fort Capital makes no guarantee, warranties, or representations as to the completeness or accuracy thereof.



FLOOR PLAN – AVAILABLE IMMEDIATELY

- » 7,136 SF Total Available
- » 4,607 SF Office
- » 2,529 SF Warehouse
- » Insulated Warehouse
- » (1) 12'x14' Grade-Level Door

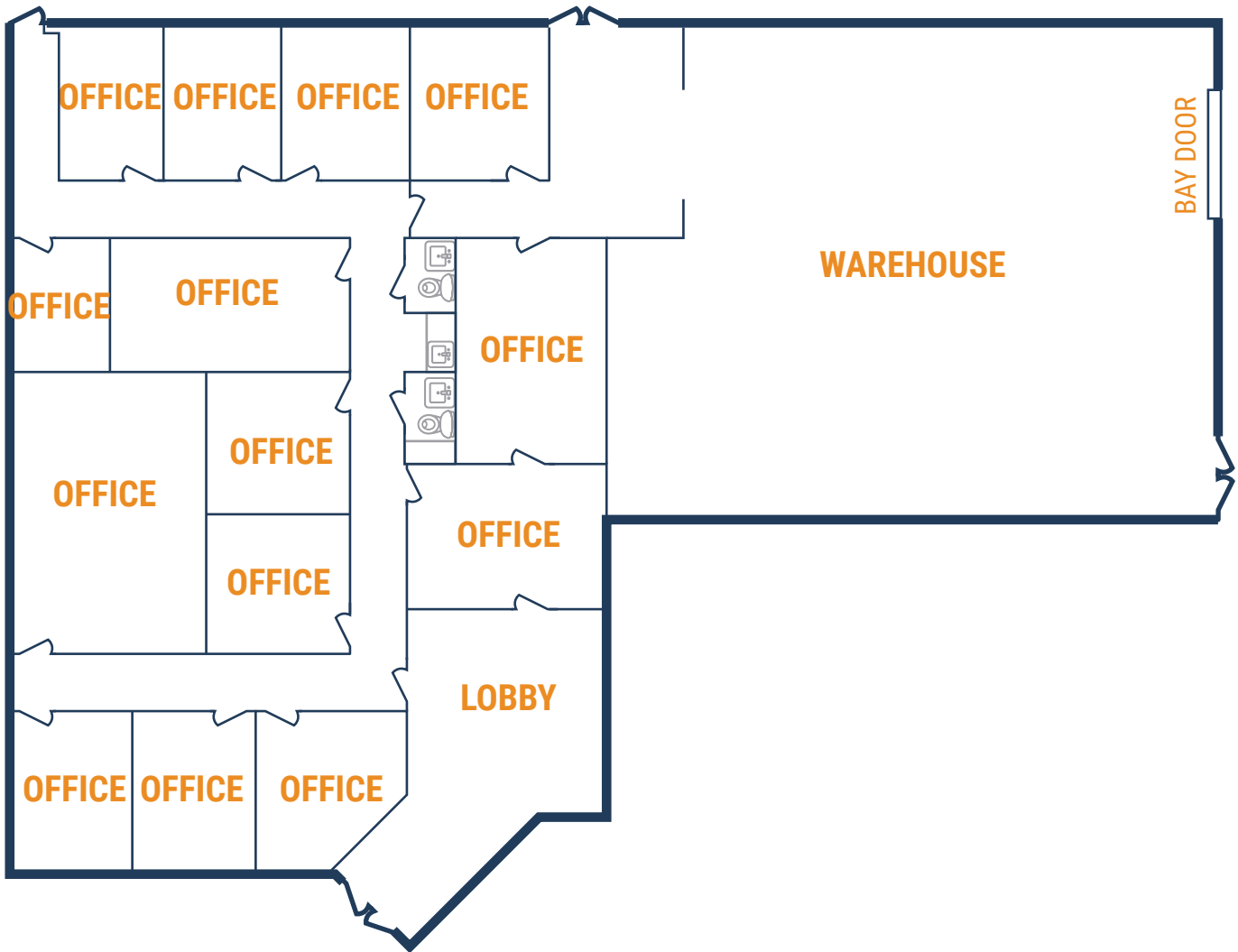

THOMAS PFEIFER



281.504.7460



THOMAS.PFEIFER@FORT-COMPANIES.COM



FLOOR PLAN – AVAILABLE IMMEDIATELY

- » 5,926 SF Total Available
- » 2,096 SF Office
- » 3,830 SF Lab/Warehouse
- » 100% Climate-Controlled
- » (1) 12'x10' Grade-Level Doors
- » 700 SF Fenced Outside Storage



THOMAS PFEIFER



281.504.7460



THOMAS.PFEIFER@FORT-COMPANIES.COM



FLOOR PLAN – AVAILABLE MAY 2024

- » 12,229 SF Total Available
- » 2,849 SF Office
- » 9,380 SF Warehouse
- » Climate-Controlled Warehouse
- » (3) Ramps

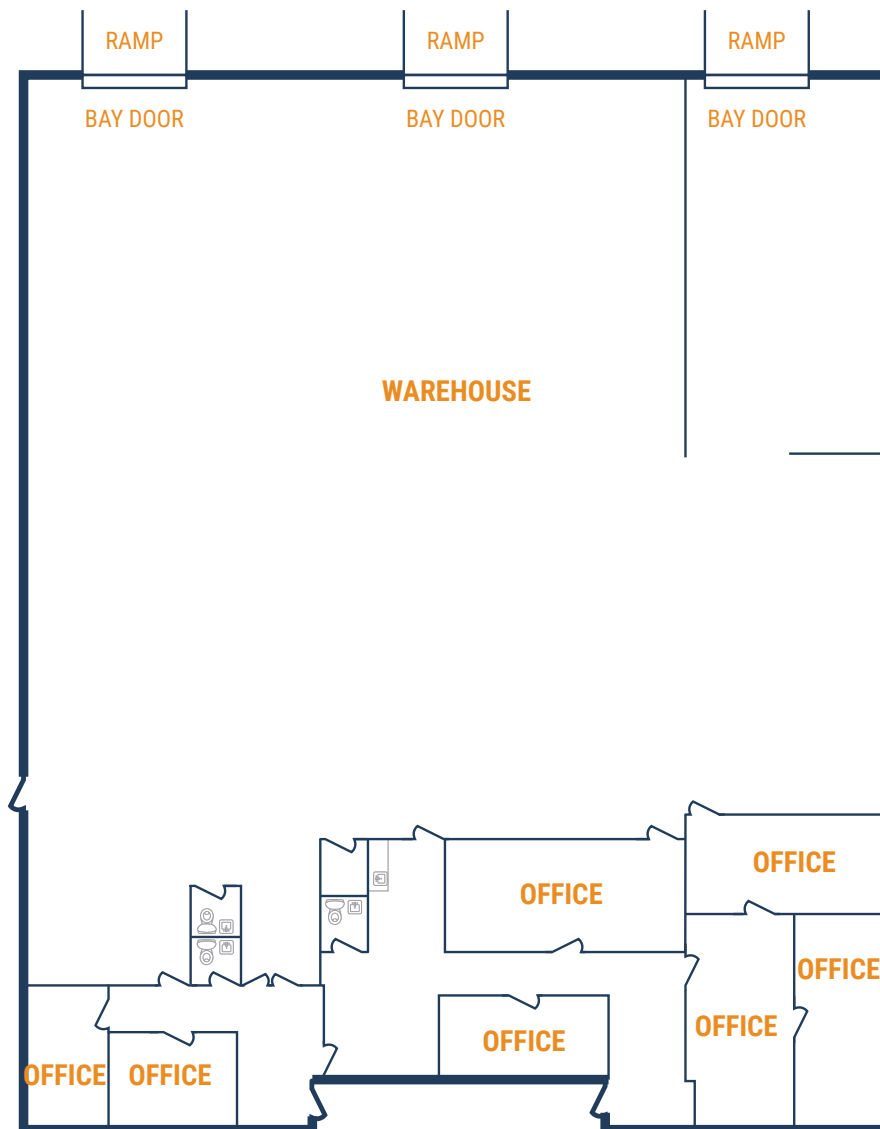

THOMAS PFEIFER



281.504.7460



THOMAS.PFEIFER@FORT-COMPANIES.COM



FLOOR PLAN – AVAILABLE IN APRIL

- » 10,561 SF Total Available
 - » 3,168 SF Office
 - » 7,393 SF Warehouse
- » (1) 12'x10' Door with Ramp
- » (1) 12'x10' Dock-High Door (well)
- » 3 Phase Power
- » Glass Storefront

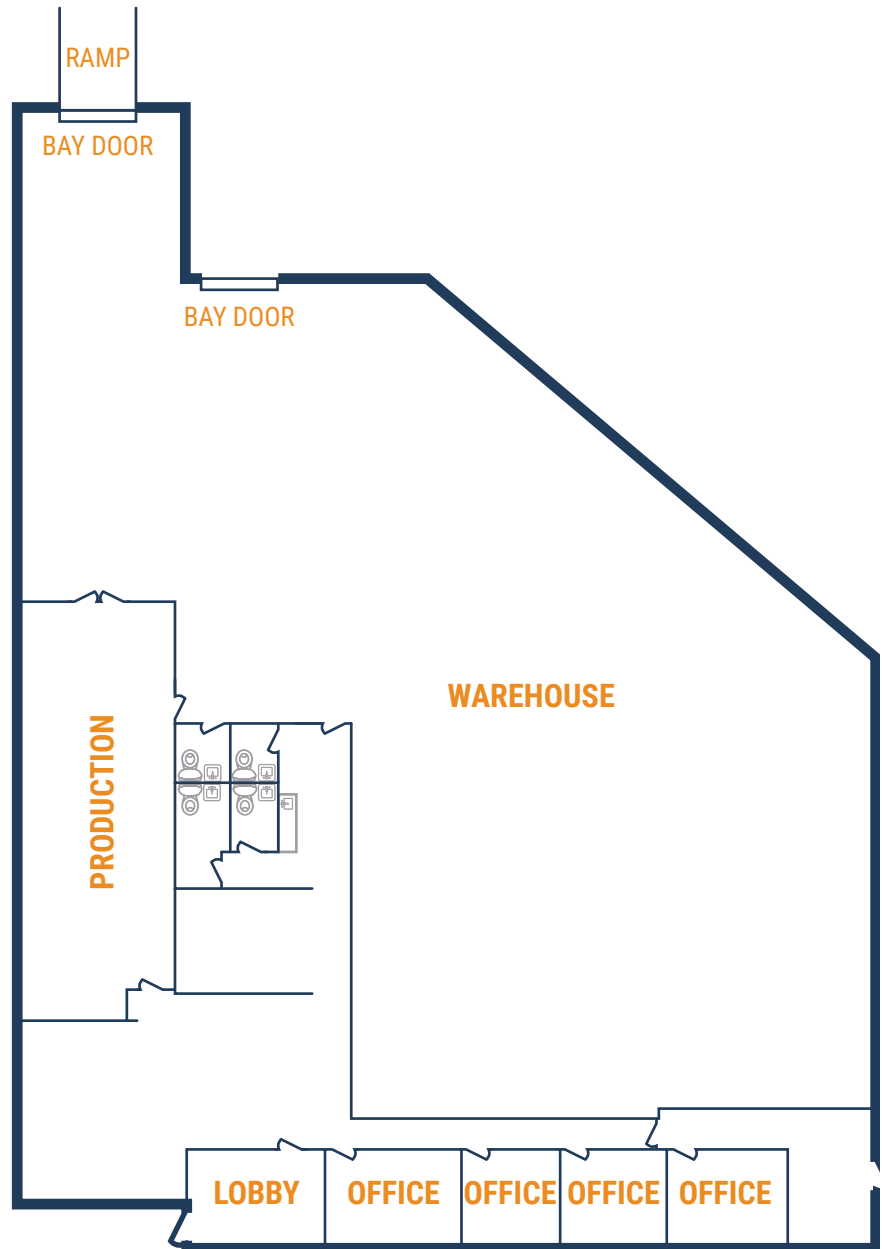

THOMAS PFEIFER



281.504.7460



THOMAS.PFEIFER@FORT-COMPANIES.COM



FLOOR PLAN – AVAILABLE IMMEDIATELY

- » 4,608 SF Total Available
- » *Build-to-Suit Office/Warehouse*
- » (1) 12'x10' Grade-Level Door with ramp



THOMAS PFEIFER



281.504.7460



THOMAS.PFEIFER@FORT-COMPANIES.COM