

EMMOTT BUSINESS CENTER

8807 – 8815 EMMOTT ROAD, HOUSTON, TX 77040



**NORTHWEST HOUSTON
SUBMARKET**



**GREAT ACCESS TO US-290
AND BELTWAY 8**



24' CLEAR HEIGHT



3-PHASE POWER (480 V)



**12'X14' GRADE-LEVEL
LOADING DOORS**



**2,400 SF – 50,000 SF
SUITES AVAILABLE**

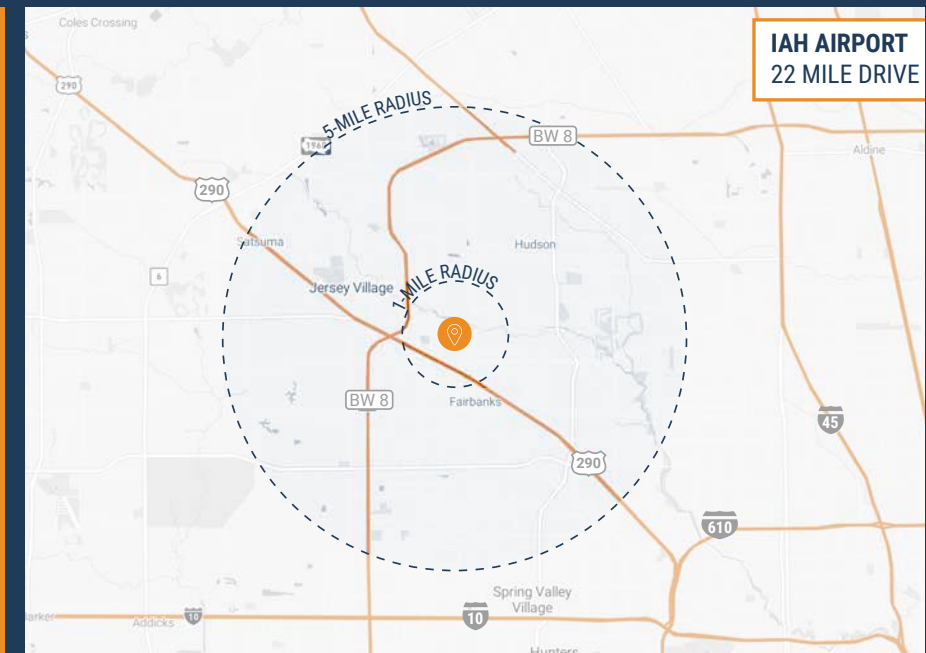

RYAN YOUNG



281.584.3320



RYAN.YOUNG@FORT-COMPANIES.COM



FORT CAPITAL

This information is deemed reliable, however, Fort Capital makes no guarantee, warranties, or representations as to the completeness or accuracy thereof.

SITE PLAN



RYAN YOUNG



281.584.3320



RYAN.YOUNG@FORT-COMPANIES.COM

This information is deemed reliable, however, Fort Capital makes no guarantee, warranties, or representations as to the completeness or accuracy thereof.

FLOOR PLAN — AVAILABLE IMMEDIATELY

- » 9,000 SF Total Available
- » 696 SF Office
- » 8,304 SF Warehouse
- » (3) Bay Doors
- » 3 Phase Power
- » Upstairs Storage

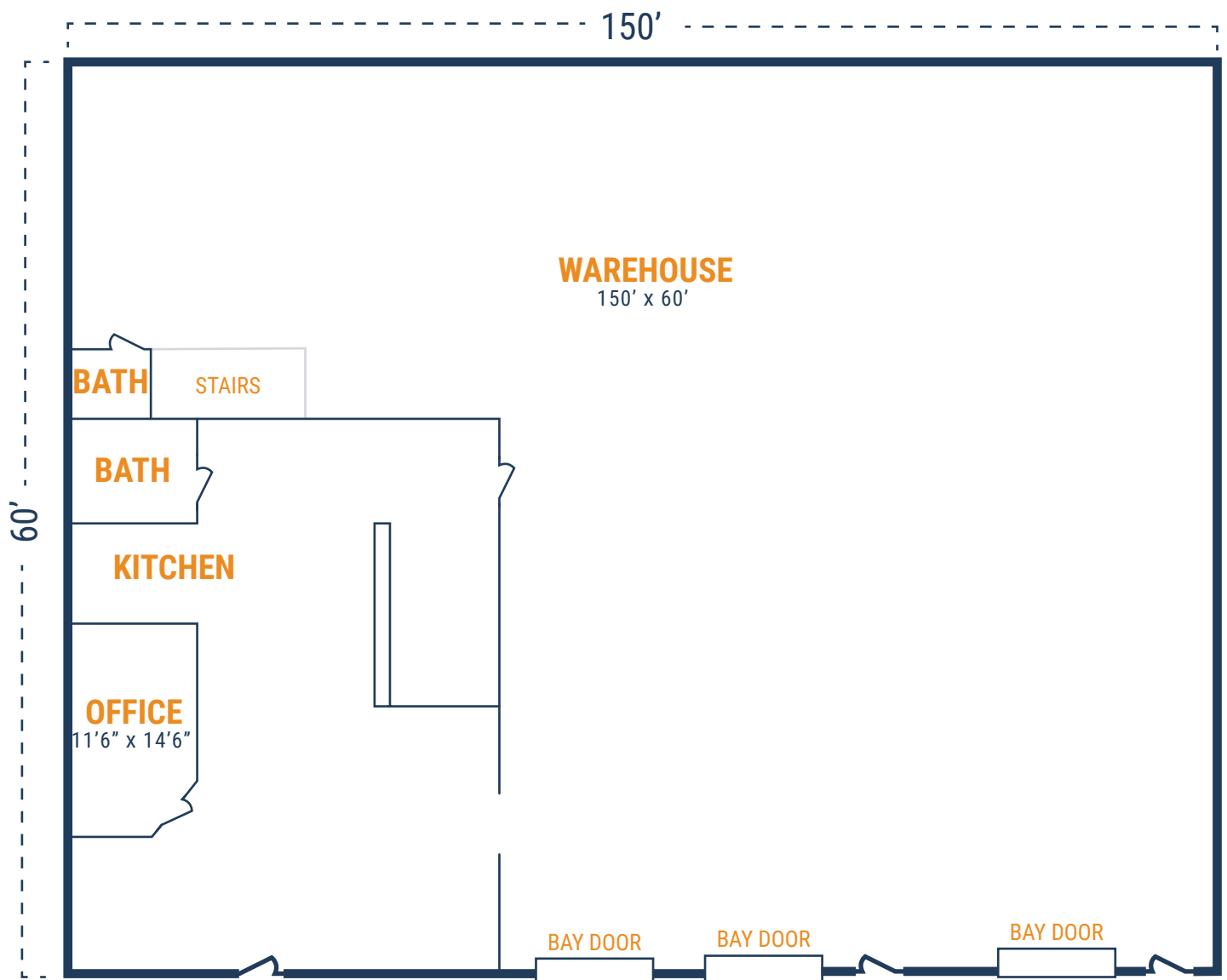

RYAN YOUNG



281.584.3320



RYAN.YOUNG@FORT-COMPANIES.COM

This information is deemed reliable, however, Fort Capital makes no guarantee, warranties, or representations as to the completeness or accuracy thereof.

FLOOR PLAN – AVAILABLE IMMEDIATELY

- » 12,000 SF Total Available
- » 4,000 SF Downstairs Office
- » 3,184 SF Upstairs Office
- » 7,100 SF Warehouse
- » (3) Bay Doors
- » 3 Phase Power

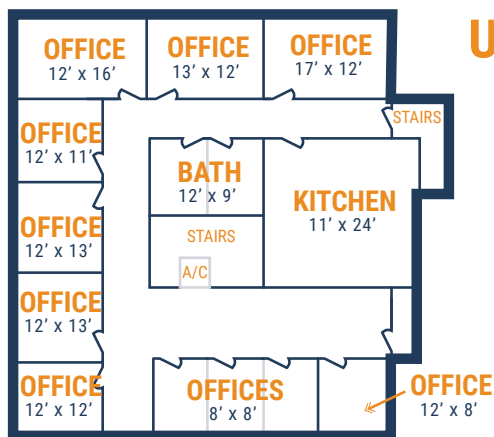
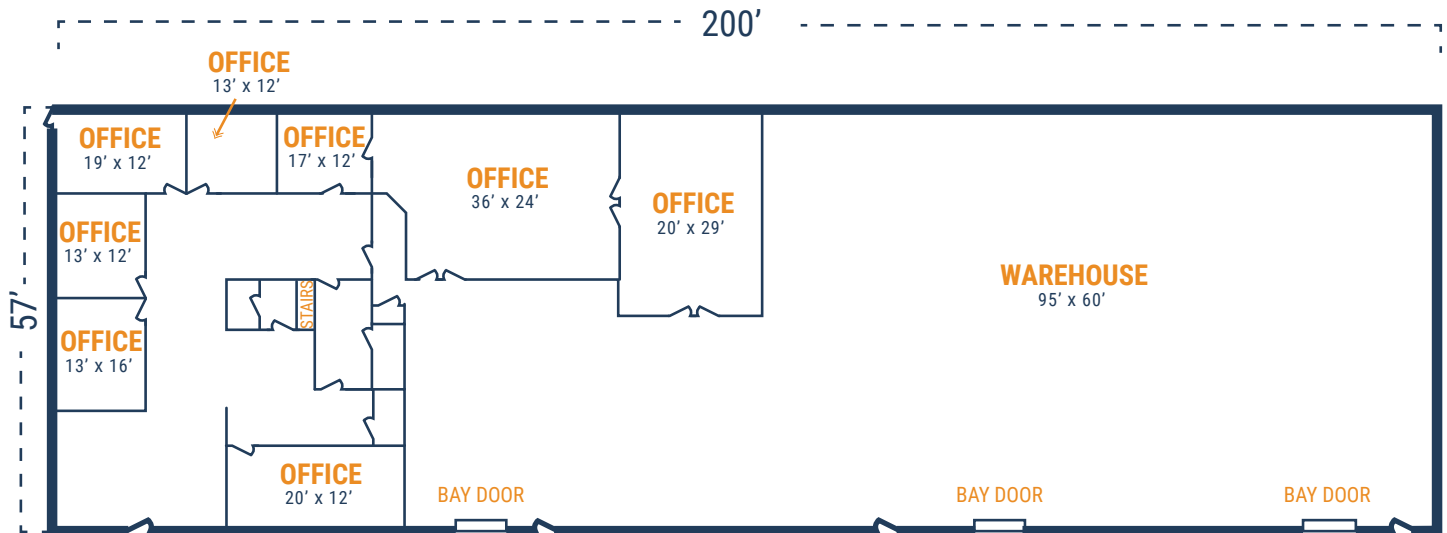

RYAN YOUNG



281.584.3320



RYAN.YOUNG@FORT-COMPANIES.COM

This information is deemed reliable, however, Fort Capital makes no guarantee, warranties, or representations as to the completeness or accuracy thereof.