

# CLEAR LAKE TECH CENTER

555 FORGE RIVER RD & 17146 – 17155 FEATHER CRAFT LN, WEBSTER, TX 77598



**2 MILES  
FROM NASA**



**GREAT ACCESS  
TO I-45**



**TILT-WALL  
CONSTRUCTION**



**3-PHASE POWER**



**6,951 SF SUITE  
AVAILABLE**

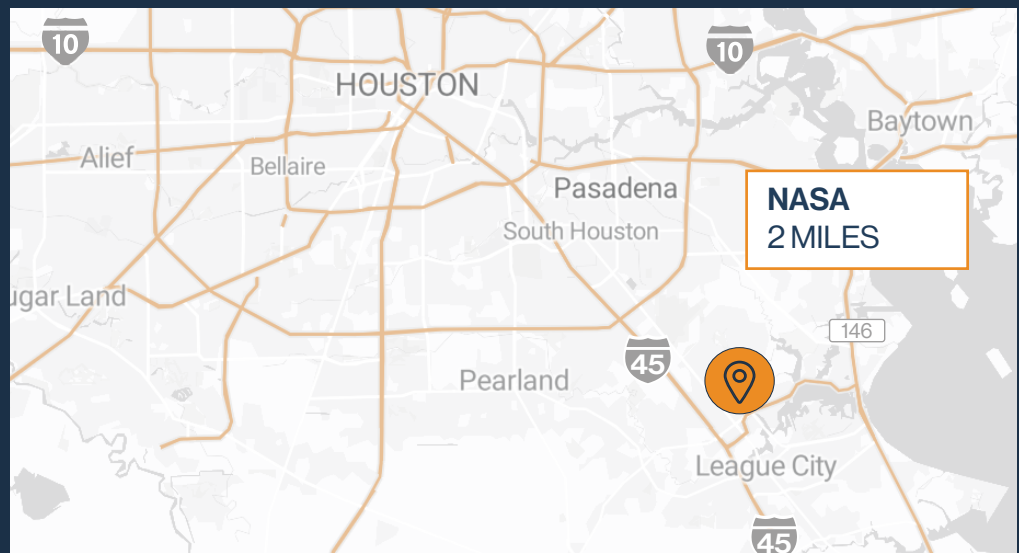

**RYAN YOUNG**



281.584.3320



RYAN.YOUNG@FORT-COMPANIES.COM



**FORT**  
LEASING

This information is deemed reliable, however, Fort makes no guarantee, warranties, or representations as to the completeness or accuracy thereof.





**FORT**  
LEASING

# CLEAR LAKE TECH CENTER

555 Forge River Rd & 17146 – 17155 Feather Craft Ln

Webster, TX 77598

## SITE PLAN



**RYAN YOUNG**



281.584.3320



RYAN.YOUNG@FORT-COMPANIES.COM

This information is deemed reliable, however, Fort makes no guarantee, warranties, or representations as to the completeness or accuracy thereof.



## FLOOR PLAN — AVAILABLE IMMEDIATELY

» 6,951 SF Total Available

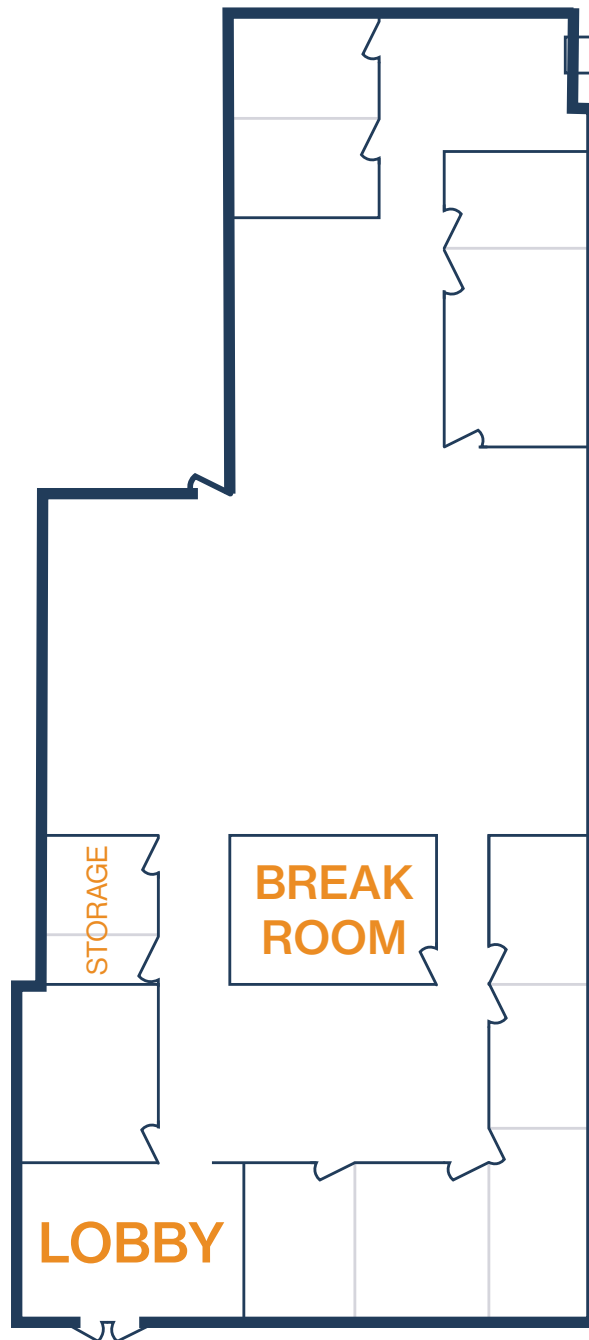

**RYAN YOUNG**



281.584.3320



RYAN.YOUNG@FORT-COMPANIES.COM



**FORT**  
LEASING

**CLEAR LAKE TECH CENTER**

17146 Feather Craft Lane, Unit 300

Webster, TX 77598

## FLOOR PLAN — AVAILABLE IMMEDIATELY

- » 5,543 SF Total Available
- » 100% Climate Controlled



**RYAN YOUNG**



281.584.3320



RYAN.YOUNG@FORT-COMPANIES.COM

This information is deemed reliable, however, Fort makes no guarantee, warranties, or representations as to the completeness or accuracy thereof.